



DSXW
Wall slot diffuser

Contents

Overview of product versions..... 2
 Function and use 2
 Models..... 3
 Mounting..... 3
 Blade position for air jet 4
 Processing..... 4
 Accessories 5
 Dimensions 6
 Dimensions of accessories..... 8
 Mounting..... 16
 Type of installation 17
 Technical data 18
 Legend 31
 Slot diffuser order code 32
 Plenum box order code 33
 Specification text 34

OVERVIEW OF PRODUCT VERSIONS

DSXW-...-Z-... (supply air) / DSXW-...-A-... (return air)

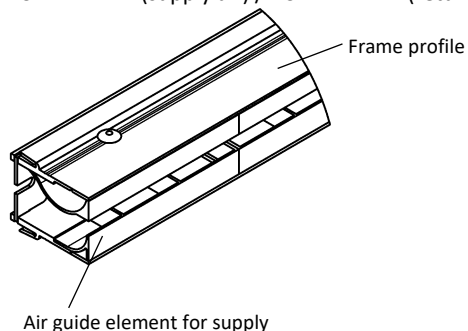

FUNCTION AND USE

The architecturally attractive narrow wall slot diffuser type DSXW-...-S0 is suitable **for installation in or at wall systems**.

The models DSXW-...-P0 and DSXW-...-PB with a continuous frame are suitable for achieving a good and clean finish when installed in a wall.

The **high induction** ensures **fast reduction of the air outflow velocity and of the temperature difference in cooling mode**.

The air outflow direction is set in-factory to a horizontal throw, directed slightly upwards (air jet direction "L"). The stable air jet means that the diffuser is suitable for VAV systems. Even at a volumetric flow of 40%, the jet still remains stable. The attached plenum box with air diffuser plate ensures a uniform distribution of supply air over the whole area of the diffuser. For an extra charge, a damper which can be adjusted from below can be mounted in the connection spigot for air volume regulation. The plenum box can also be insulated either internally or externally.

A band design with plenum box is delivered with concealed mounting as standard.

For slot diffusers in band design with concealed mounting, the fastening effort is reduced by half, compared with the model without concealed mounting.

Note:

We would like to point out that the diffusers must be mounted, before panelling the walls.

Diffuser mounting

Fixing lugs are provided in the plenum box to allow the diffuser to be suspended (see page 13). These fixing lugs can be provided with M6 riveting nuts at an extra charge.

MODELS

DSXW-1-...	1-slot
DSXW-2-...	2-slot
DSXW-3-...	3-slot
DSXW-4-...	4-slot
DSXW-...-Z	supply air
DSXW-...-A	return air (with air guide elements)
DSXW-...-S0	with narrow frame profile, without support profile, for invisible installation (standard).
DSXW-...-P0	with frame profile P0, with support profile, for visible installation.
DSXW-...-PB	with frame profile PB, with support profile, for visible installation.
DSXW-...-L	Air guide elements one-way horizontal throw diagonally upwards (standard).
DSXW-...-N	single design (length max. 1500 mm).
DSXW-...-B	band design (available lengths according to SCHAKO standard for band design, single element length max. 1500 mm). To lock the slot diffusers, double air guide elements are used at the butt joints (supplied loose, installation on site).

MOUNTING

Without connection (-00)

- Slot diffuser and plenum box are **not** connected to one another.
- Standard with dummy piece (-BS) and with mounting bracket (-BW).

Concealed mounting with plenum box (-VM, standard)

- Slot diffuser and plenum box are connected to one another ex works.
- The slot diffuser is screwed to the plenum box housing (face part) with concealed screws.

Clamp strap (-KB)

- Only possible without plenum box.
- Screws and clamp straps are supplied loose (pair).
- Possible for the models DSXW-...-P0 and DSXW-...-PB.
- Not possible for model DSXW-...-S0.
- The slot diffuser is screwed to the clamp strap with concealed screws (included in delivery).
- **For mounting, access on the rear is not required!**

Suspension via fastening holes

- Model:
 - dummy piece design (-BS).
 - mounting bracket design (-BW, pair).
- Only possible without plenum box.
- The slot diffuser is fastened to 4 suspension brackets.

BLADE POSITION FOR AIR JET

All air guide elements will be set in one direction when ordering multi slot models.

Supply air and return air with air guide elements.

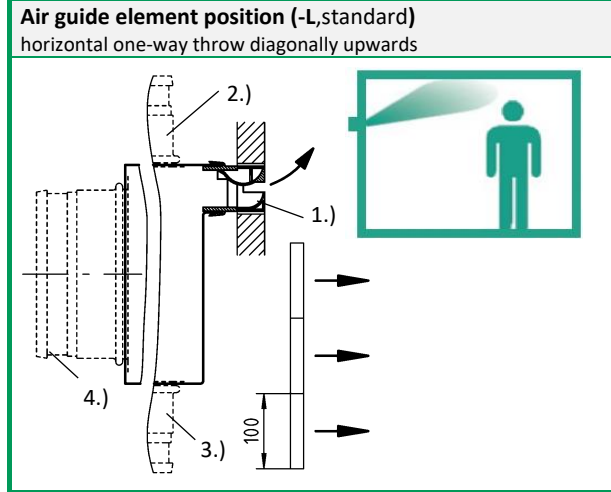

- 1.) Air guide element
- 2.) Lateral spigot (-S1)
- 3.) Lateral spigot located on the opposite side (-S2)
- 4.) Spigot from above (-S0) (standard)

PROCESSING

Frame surface

- Natural colour anodised aluminium (-ELOX, standard for model DSXW-...-PO and DSXW-...-PB).
- Painted aluminium (standard for DSXW-...-S0 model and painted to the same colour as blade colour of air guide element):
 - RAL 9005 (black) (-9005).
 - RAL 9010 (white) (-9010).
 - painted to a different RAL colour (freely selectable, at an extra charge) (-xxxx, always with 4 digits).

Blade colour (air guide element)

- Plastic:
 - Colour similar to RAL 9005 (black, standard) (-L9005).
 - Colour similar to RAL 9010 (white) (-L9010).
- Installation position of air guide element (standard), for supply and return air (air guide element position -L).
- Double air guide elements for band design (supplied loose).

Spacer tube

- Aluminium

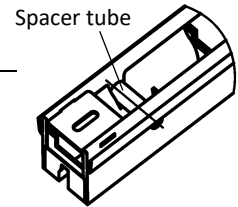

Connection element

- for band design.
- for connection between (see page 14):

DSXW-...-ASK	with	DSXW-...-ASK	active - active
DSXW-...-ASK	with	DSXW-...-BW	active - active
DSXW-...-ASK	with	DSXW-...-BS	active - passive
DSXW-...-BW	with	DSXW-...-BW	active - active
DSXW-...-BW	with	DSXW-...-BS	active - passive
DSXW-...-BS	with	DSXW-...-BS	passive - passive

- made of galvanised sheet steel.
- supplied loose as standard.

ACCESSORIES

Plenum box (-ASK-23)

- Model (number of slots):
 - 1-slot (-1).
 - 2-slot (-2).
 - 3-slot (-3).
 - 4-slot (-4).
- Single / band design:
 - Single design (-N, length of box KL max. 1500 mm).
 - Band design (-B, available lengths according to SCHAKO standard for band design).
- Length:
 - Length L = 1000 mm (-01000) (KL = 995 mm).
 - Length L = 1500 mm (-01500) (KL = 1495 mm).
 - Length (L/BL) in mm, freely selectable (-xxxx, always with 5 digits) (length of box KL = L-5 / total length of box GKL = BL-5, can be fitted with a plenum box in case of single design lengths L = ≥400 mm to ≤1500 mm).
- Mounting of box:
 - without connection (-00) (not connected to the slot diffuser, screws supplied loose).
 - Concealed mounting (-VM) (connected to the slot diffuser ex works).
- Material:
 - Galvanised sheet steel (-SV) (standard).
- Damper:
 - without damper (-DK0) (standard).
 - with damper and cable-operated adjustment (-DK2) made of galvanised sheet steel, in the connection spigot, adjustable, for simple air volume regulation.
- Rubber lip seal:
 - without rubber lip seal (-GD0) (standard).
 - with rubber lip seal (-GD1) made of special rubber, at the connection spigot.
- Insulation:
 - without insulation (-I0) (standard).
 - with internal insulation (-li), thermal insulation inside the plenum box.
 - with external insulation (-la), thermal insulation at the outside of the plenum box.
- Height of plenum box:
 - Standard height of plenum box (-KHS).
 - Height of box in mm, freely selectable (-xxx, always with 3 digits) (minimum height [GH] with spigot position S1+S2 and standard box neck = spigot diameter $\varnothing D + 82$ mm / with spigot position S0 = 180 mm).
- Box neck:
 - Box neck standard (-KVS) (KVS = 45 mm).
 - Box neck extension in mm, freely selectable (-xxx, always with 3 digits). Box neck (not adjustable) from ≥45 mm to 200 mm possible.
- Spigot position:
 - Spigot from above (-S0) (standard).
 - Lateral spigot (-S1).
 - Lateral spigot located on the opposite side (-S2).
- Spigot diameter:
 - Standard spigot diameter (-SDS).
 - Spigot diameter ($\varnothing D$) in mm, freely selectable (-xxx, always with 3 digits).
- Suspension:
 - without riveting nut (-E0) (standard).
 - With riveting nut (-EM), made of brass.
- With air diffuser plate, made of galvanised sheet steel.
- Connection plate for band design (2x per butt joint), made of galvanised sheet steel. Number of suspension (without / with riveting nuts) per butt joint is reduced from 4x to 2x.

End pieces (-E0/-ES/-EB/-EL/-ER)

- Without end pieces (-E0) (standard).
- with end pieces, made of aluminium (same colour as frame):
 - Supplied loose (-ES, pair) (standard).
 - Mounted ex works on both sides (-EB).
 - Mounted ex works on the left side (-EL).
 - Mounted ex works on the right side (-ER).

Mounting bracket (pair) / dummy piece (-B0/-BW/-BS)

- without mounting bracket / without dummy piece (-B0).
- with mounting bracket (-BW), for overflow operation:
 - made of galvanised sheet steel.
 - Only possible without plenum box.
 - possible from length L ≥ 200 mm.
- with dummy piece (-BS):
 - made of galvanised sheet steel.
 - Only possible without plenum box.
 - possible from length L ≥ 200 mm.

With models -BW and -BS as a band, additional connecting fishplates are supplied loose.

DIMENSIONS

Dimensions of frame profile

Narrow frame profile "S0" (standard)

For invisible installation.

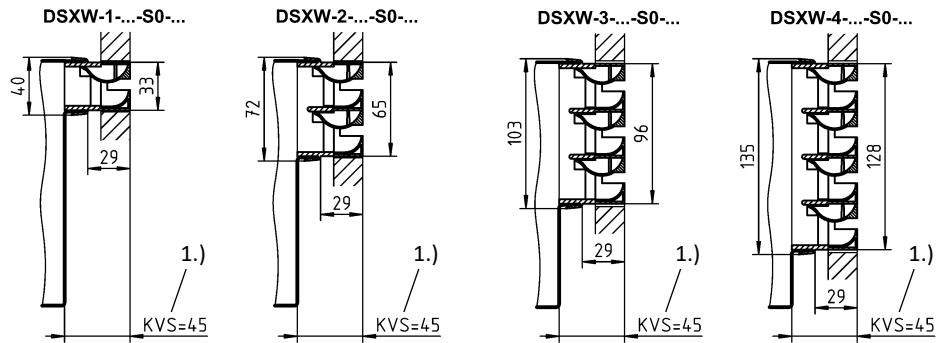

Frame profile "P0" (with support profile)

For visible installation.

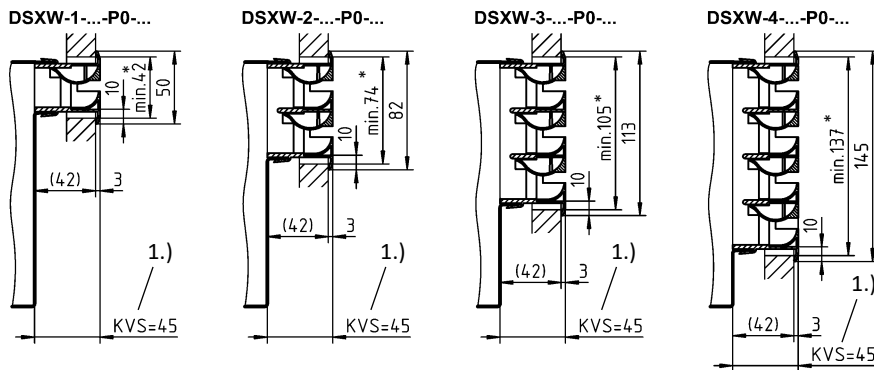

Frame profile "PB" (with support profile)

For visible installation

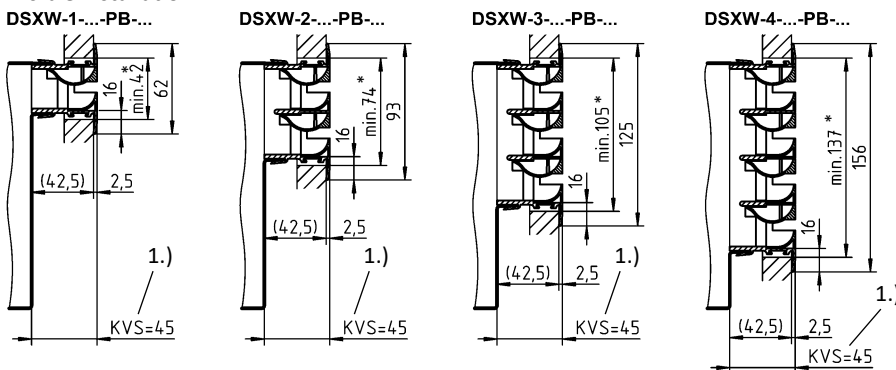

* EÖB = installation opening width (minimum dimension)

EÖL = installation opening length

1.) Box neck

Installation opening

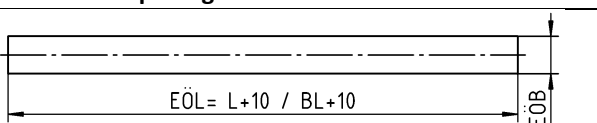

Available lengths for the slot diffuser

Single design (-N)

- Length L= 1000 mm (-N-01000).
- Length L= 1500 mm (-N-01500).
- Length (L) in mm, freely selectable (-N-xxxxx) (always with 5 digits)
(in case of single design length $L \geq 400$ mm to ≤ 1500 mm can be fitted with plenum box, dummy piece possible from length ≥ 200 mm).

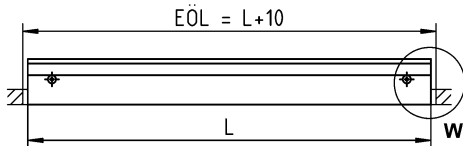

Band design (-B)

- Length (BL) in mm, freely selectable, as band (-B-xxxxx) (always with 5 digits).

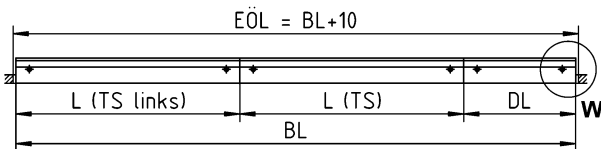

Available lengths according to SCHAKO standard:

When the slot diffuser type DSXW is designed as a band, the total length BL is assembled from lengths (sections) of **1000 mm or 1500 mm** (standard). The difference pieces DL are supplied in lengths **≥ 400 mm to < 1500 mm**. The difference pieces from **≥ 200 mm to < 400 mm** are supplied as dummy pieces without plenum box.

To lock the slot diffusers, double air guide elements are used at the butt joints (supplied loose, installation on site).

TS	= section
Left TS	= left section
L	= length
DL	= difference in length
BL	= band length
EÖB	= installation opening width
EÖL	= installation opening length ($EÖL = L+10 / BL+10$)

End pieces, for detail W see page 8.

DIMENSIONS OF ACCESSORIES

End pieces (-E0/-ES/-EB/-EL/-ER)

- Without end pieces (-E0) (standard).
- with end pieces, made of aluminium (same colour as frame):
 - Supplied loose (-ES, pair) (standard).
 - Mounted ex works on both sides (-EB).
 - Mounted ex works on the left side (-EL).
 - Mounted ex works on the right side (-ER).

To give the impression of a continuous frame, lateral front end pieces can be fitted.

for DSXW-...-S0:

for DSXW-...-P0:

for DSXW-...-PB:

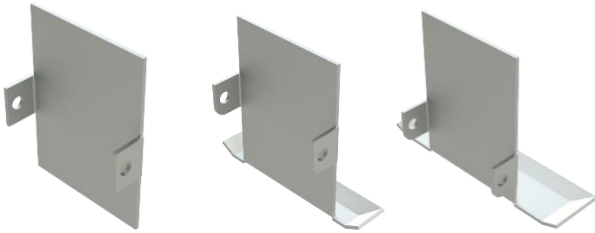

End piece on both sides (-EB)

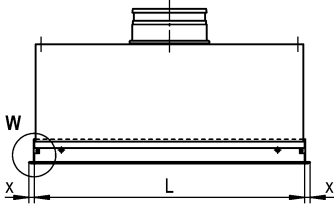

End piece on the left (-EL)

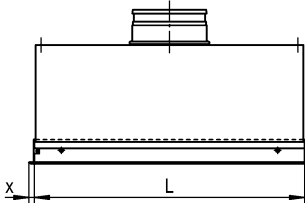

End piece on the right (-ER)

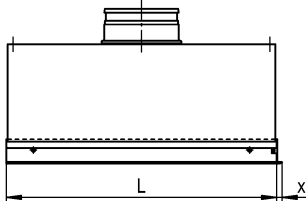

Detail W

DSXW-...-S0

without end pieces

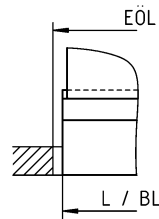

with end pieces

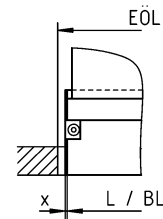

DSXW-...-P0 / DSXW-...-PB

without end pieces

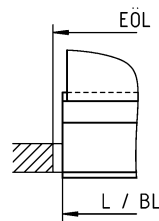

with end pieces

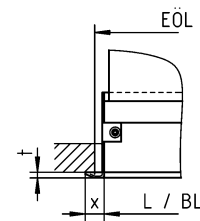

	x	t
DSXW-...-S0	1	-
DSXW-...-P0	10	3
DSXW-...-PB	16	2.5

Installation opening in the length section:

EÖL = L + 10 or BL + 10

Mounting bracket (pair) / dummy piece (-B0/-BW/-BS)

- without mounting bracket / without dummy piece (-B0)
- with mounting bracket (-BW), for overflow operation:
 - made of galvanised sheet steel.
 - Only possible without plenum box.
 - possible from length $L \geq 200$ mm.
- with dummy piece (-BS):
 - made of galvanised sheet steel.
 - Only possible without plenum box.
 - possible from length $L \geq 200$ mm.

With models -BW and -BS as a band, additional connecting fishplates are supplied loose.

Mounting with suspension via mounting holes (4x) (see page 16).

Mounting bracket (-BW)

DSXW-1-...-BW (1-slot) **DSXW-2 to 4-...-BW** (2- to 4-slot)

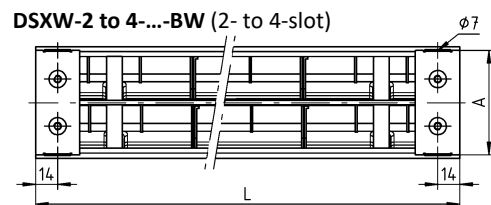
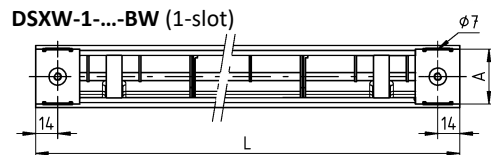
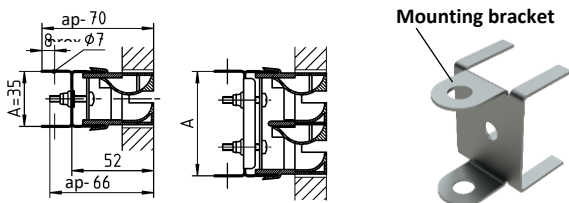

Dummy piece (-BS)

DSXW-1-...-BS (1-slot) **DSXW-2 to 4-...-BS** (2- to 4-slot)

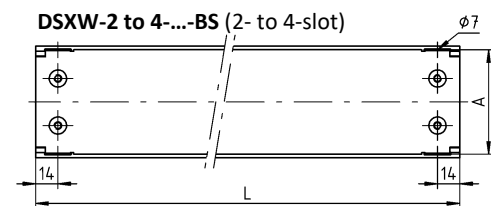
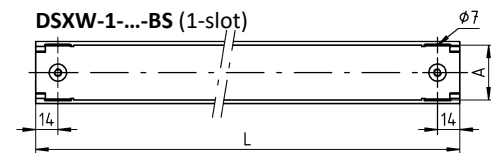
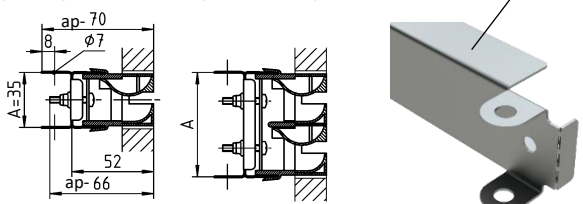

	DSXW-1-...	DSXW-2-...	DSXW-3-...	DSXW-4-...
A	35	67	98	130

Construction subject to change
No return possible

Plenum box (-ASK-23)

Spigot position

- S0 = spigot from above (standard)
- S1 = lateral spigot
- S2 = lateral spigot on the opposite side

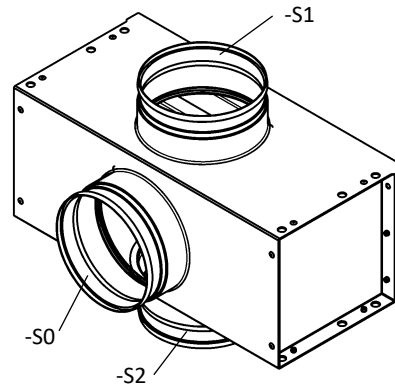

Dimensions of the plenum box: see pages 10 to 12.

PLENUM BOX – SINGLE DESIGN (-N)

Plenum box (-ASK-23-...-N-...-VM-...-S0-...)

With concealed mounting. With spigot from above.
The slot diffuser is screwed to the plenum box housing (face part) with concealed screws.

Spigot from above (-S0, standard)

DSXW-...-ASK-23-...-N-...-VM-...-S0-...

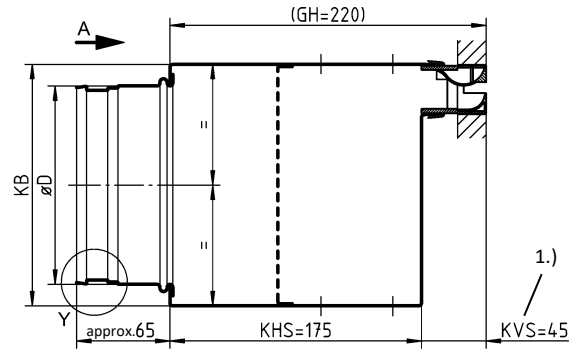

1.) Box neck

Available sizes for plenum box (-ASK) (-ASK-23-...-N-...-VM-...-S0-...)

	Length					
	L ≥ 400 to L ≤ 500		L > 500 to L ≤ 1000		L > 1000 to L ≤ 1500	
	KB	øD	KB	øD	KB	øD
DSXW-1	168	1 x ø138	168	1 x ø138	168	2 x ø138
DSXW-2	168	1 x ø138	168	2 x ø138	168	3 x ø138
DSXW-3	188	1 x ø158	188	2 x ø158	188	3 x ø158
DSXW-4	228	1 x ø198	228	2 x ø198	228	3 x ø198

L	KL	EÖL
1000	995	1010
1500	1495	1510

Available lengths plenum box (-ASK-21-...-N)

- Length L = 1000 mm (-N-01000) (length of box KL = 995 mm).
- Length L = 1500 mm (-N-01500) (length of box KL = 1495 mm).
- Length (L) in mm, freely selectable (-N-xxxxx) (always with 5 digits).
(Length of box KL = L-5, can be fitted with a plenum box in case of single design lengths L = ≥400 mm to ≤1500 mm.)

Spigot position:

Spigot from above (-S0)

View A / with 1 spigot

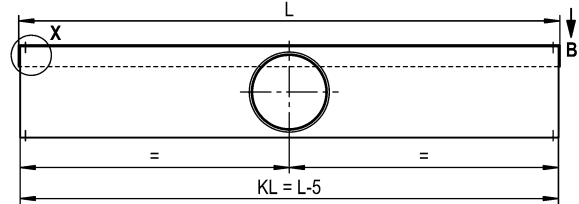

View A / with 2 spigots

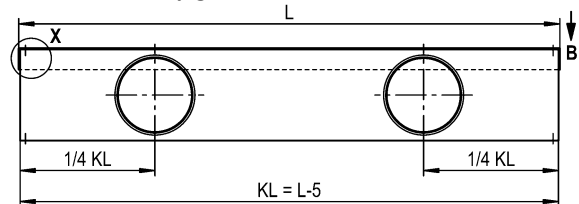

View A / with 3 spigot

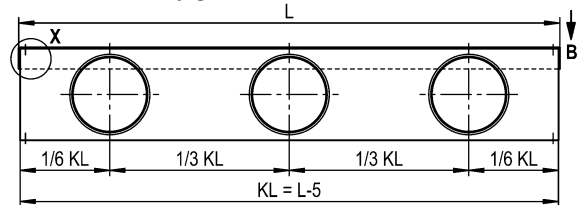

Plenum box height reduction (at an extra charge)

- for spigot position -S0 and standard box neck:
The height of box [GH] can be reduced to 180 mm.

Box neck extension

- Box neck standard (KVS = 45 mm) (-KVS).
- Box neck extension in mm, freely selectable (-xxx, always with 3 digits), box neck (not adjustable) from ≥45 mm to 200 mm possible.

Spigot diameter:

- Standard spigot diameter (-SDS).
- Spigot diameter (øD) in mm, freely selectable (-xxx, always with 3 digits).

Intermediate lengths and other spigot diameters on request.

Attention: The max. torque of the fastening screw is 0.5 Nm.

EÖB = installation opening width (see page 6)
EÖL = installation opening length (EÖL = L+10 / BL+10)

For the position of suspension view B, see page 13.

For plenum box suspension, detail X, see page 13.

For rubber lip seal, detail Y, see page 15.

See page 16 for mounting.

For plenum box in band design, see page 12.

PLENUM BOX – SINGLE DESIGN (-N)

Plenum box (-ASK-23-...-N-...-VM-...-S1/-S2-...)

With concealed mounting. With lateral spigot (-S1) or with lateral spigot located on the opposite side (-S2). The slot diffuser is screwed to the plenum box housing (face part) with concealed screws.

With lateral spigot (-S1)

DSXW-...-ASK-23-...-N-...-VM-...-S1-...

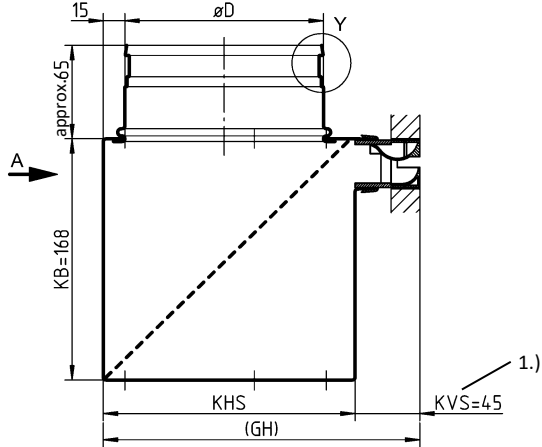

With lateral spigot located on the opposite side (-S2)

DSXW-...-ASK-23-...-N-...-VM-...-S2-...

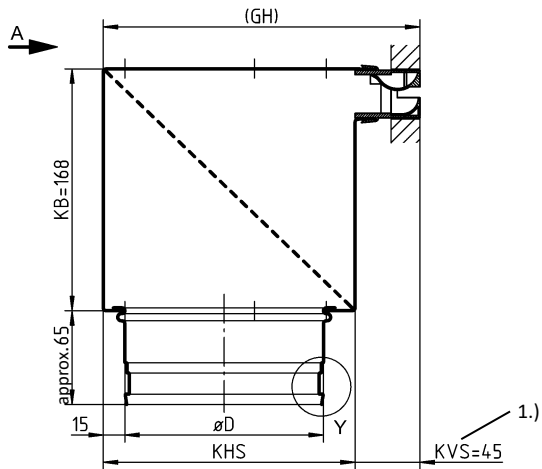

1.) Box neck

Available sizes for plenum box (-ASK) (-ASK-23-...-N-...-VM-...-S1/S2-...)

	Length L ≥ 400 to L ≤ 500			Length L > 500 to L ≤ 1000			Length L > 1000 to L ≤ 1500		
	KHS	GH	øD	KHS	GH	øD	KHS	GH	øD
DSXW-1	175	220	1 x ø138	175	220	1 x ø138	175	220	2 x ø138
DSXW-2	175	220	1 x ø138	175	220	2 x ø138	175	220	3 x ø138
DSXW-3	195	240	1 x ø158	195	240	2 x ø158	195	240	3 x ø158
DSXW-4	235	280	1 x ø198	235	280	2 x ø198	235	280	3 x ø198

L	KL	EÖL
1000	995	1010
1500	1495	1510

Attention:
The max. torque of the fastening screw is 0.5 Nm.

EÖB = installation opening width (see page 6)
EÖL = installation opening length (EÖL = L+10 / BL+10)

Available lengths plenum box (-ASK-21-...-N)

- Length L = 1000 mm (-N-01000) (length of box KL = 995 mm).
- Length L = 1500 mm (-N-01500) (length of box KL = 1495 mm).
- Length (L) in mm, freely selectable (-N-xxxxx) (always with 5 digits).
(Length of box KL = L-5, can be fitted with a plenum box in case of single design lengths L = ≥400 mm to ≤1500 mm.)

Spigot position:

lateral spigot (-S1) / lateral spigot located on the opposite side (-S2)

View A / with 1 spigot

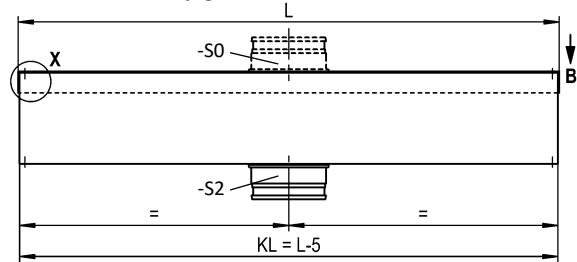

View A / with 2 spigots

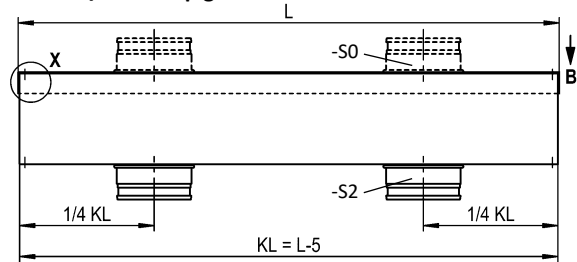

View A / with 3 spigots

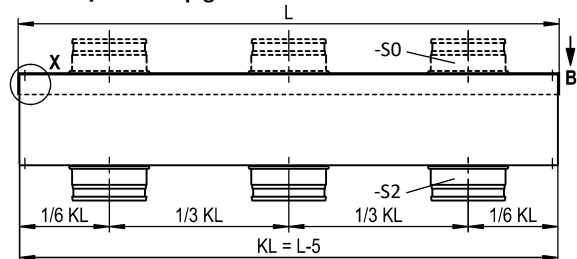

Plenum box height reduction (at an extra charge)

- for spigot position -S1/-S2 and standard box neck: Minimum height [GH] = spigot diameter øD + 82 mm.

Box neck extension

- Box neck standard (KVS = 45 mm) (-KVS).
- Box neck extension in mm, freely selectable (-xxx, always with 3 digits), box neck (not adjustable) from ≥45 mm to 200 mm possible.

Spigot diameter:

- Standard spigot diameter (-SDS).
- Spigot diameter (øD) in mm, freely selectable (-xxx, always with 3 digits).

Intermediate lengths and other spigot diameters on request.

For the position of suspension view B, see page 13.
For plenum box suspension, detail X, see page 13.
For rubber lip seal, detail Y, see page 15.
See page 16 for mounting.
For plenum box in band design, see page 12.

PLENUM BOX – BAND DESIGN (-B)

Plenum box (-ASK-23-...-B-...-VM-...)

With concealed mounting.
 The slot diffuser is screwed to the plenum box housing (face part) with concealed screws.

Available lengths of plenum box (-ASK-23-...-B)

DSXW-...-ASK-23-...-B-...-VM-...-S0-...-E0
 (with spigot from above, without riveting nut)

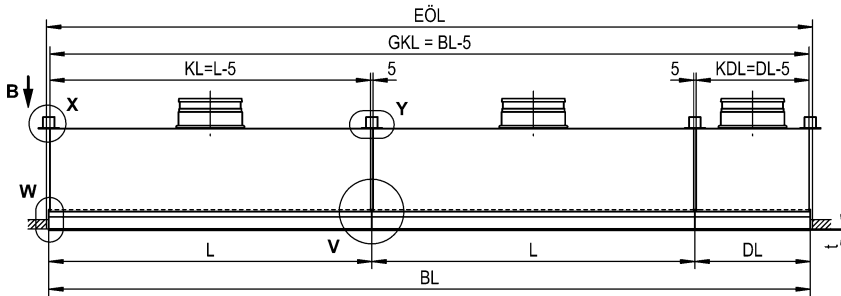

DSXW-...-ASK-23-...-B-...-VM-...-S0-...-ES/-EB/-EL/-ER
 (with spigot from above, with riveting nut)

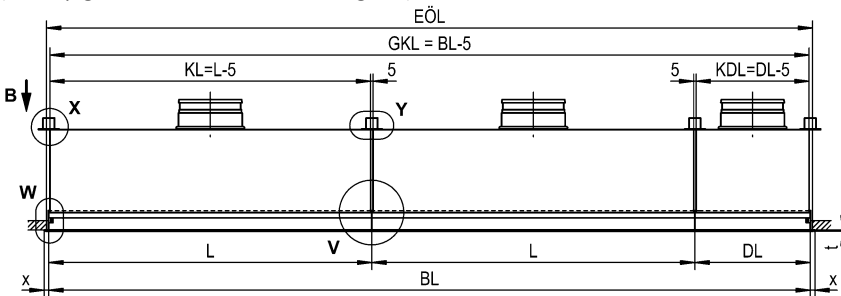

DSXW-...-ASK-23-...-B-...-VM-...-S1/S2-...-E0
 (with lateral spigot (-S1) or with lateral spigot located on the opposite side (-S2), without riveting nut)

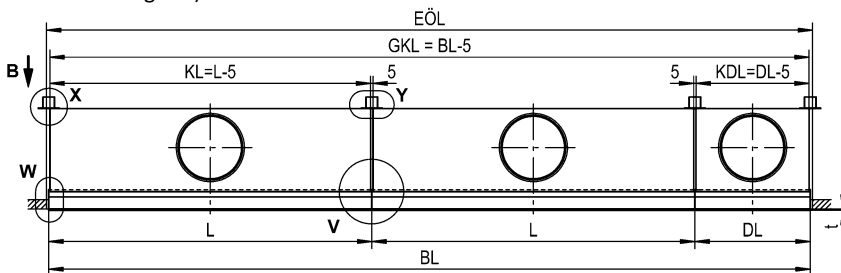

DSXW-...-ASK-23-...-B-...-VM-...-S1/S2-...-ES/-EB/-EL/-ER
 (with lateral spigot (-S1) or with lateral spigot located on the opposite side (-S2), without riveting nut)

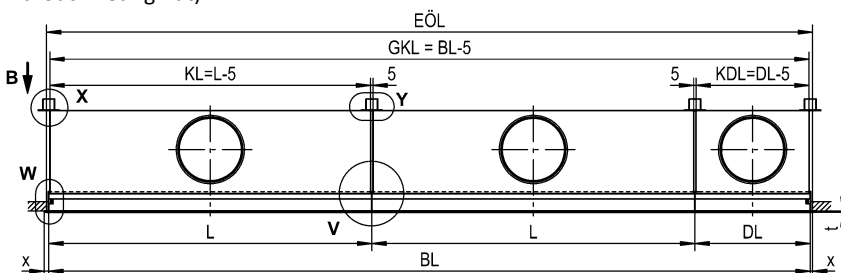

Available lengths according to SCHAKO standard

BL >1500 to <2000:
 For models designed as a band (BL > 1500 mm to <2000 mm), the total length BL is divided individually (division upon request).

BL ≥2000:
 For models designed as a band (BL ≥ 2000 mm), the total length BL is assembled from standard lengths of **1500 mm**.

The difference pieces DL with length <1500 mm to ≥ 400 mm can be fitted with a plenum box.

A plenum box (KL/KDL) with a length of <400 mm is not possible.

The difference pieces from <400 mm to ≥200 mm are supplied as dummy pieces without plenum box. A different band division is possible after consultation and when required by the customer. Individual sections are connected (for mounting on site, see detail V) by using double air guide elements.

	x	t
DSX-...-S0	1	-
DSX-...-P0	10	3
DSX-...-PB	16	2.5

Installation opening in the length section:
EÖL = BL + 10

- L = length
- DL = difference in length
- BL = band length
- KL = length of plenum box (KL = L-5)
- KDL = difference in length, plenum box (KDL = DL-5)
- GKL = total length of box (GKL = BL-5)
- EÖL = ceiling opening dimensions

Butt joint of concealed mounting, for detail V see page 13.
 For plenum box suspension, detail X / detail Y, see page 13.
 End pieces, for detail W see page 8.

For the position of suspension holes view B, see page 13.
 Available sizes for plenum box see pages 10 + 11.

Butt joint of concealed mounting (-VM)

Detail V

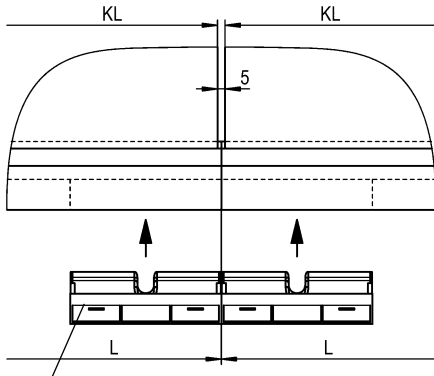

Double air guide element, supplied loose (assembly on site)

Position of the suspension holes

SINGLE DESIGN

View B

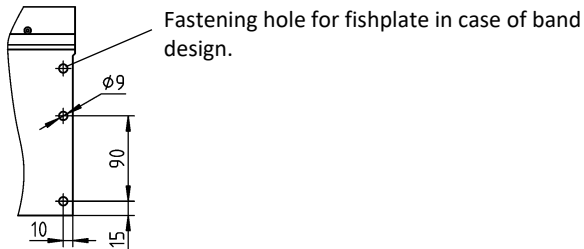

BAND DESIGN

View B

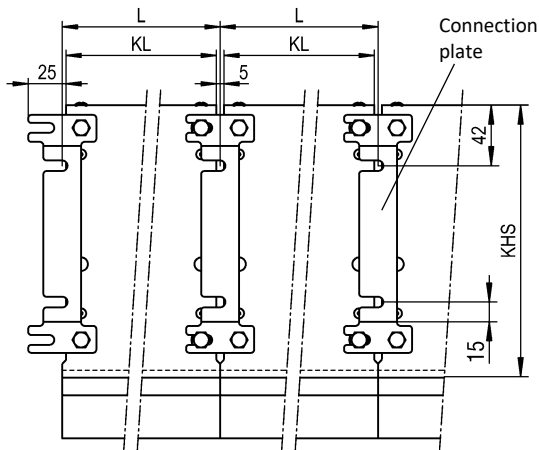

Dimensions of KHS+KB see pages 10 + 11.

Connection plate

with long hole
(-E0, standard):

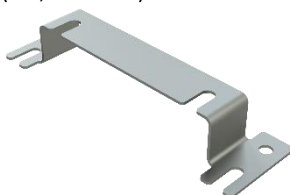

with riveting nut M6
(-EM, at an extra charge):

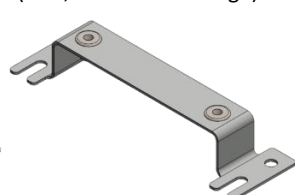

Plenum box suspension

SINGLE DESIGN

Detail X

mit hole ø 9 (-E0, standard):

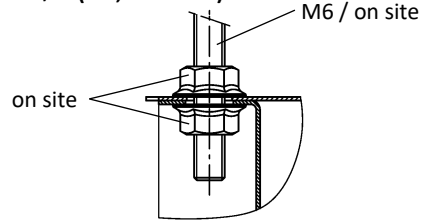

with riveting nut M6 (-EM, at an extra charge):

At an extra charge, the plenum boxes can be fitted with M6 riveting nuts to facilitate ceiling mounting.

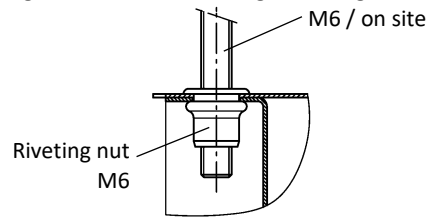

BAND DESIGN

with long hole (-E0, standard):

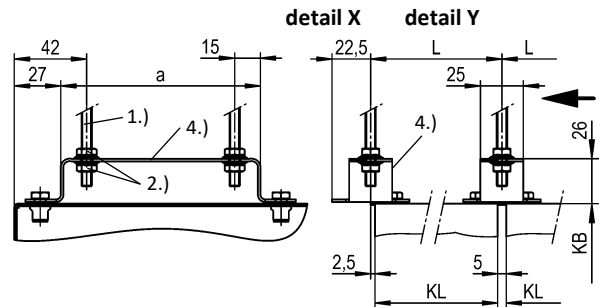

with riveting nut M6 (-EM, at an extra charge):

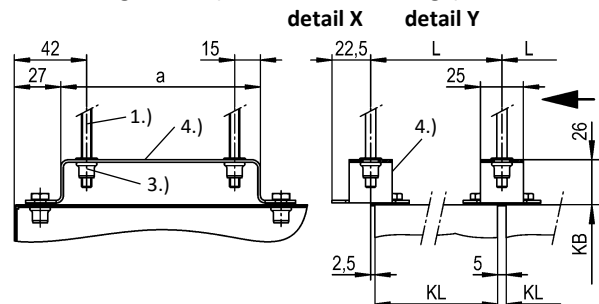

At an extra charge, the plenum boxes can be fitted with M6 riveting nuts to facilitate ceiling mounting.

$a = KHS - 63.5 \text{ mm}$

- 1.) Threaded rod M6 on site
- 2.) Nut M6 on site
- 3.) Riveting nut M6
- 4.) Connection plate

Connection element for band design

(supplied loose as standard)

DSXW-...-ASK with DSXW-...-ASK (active – active)

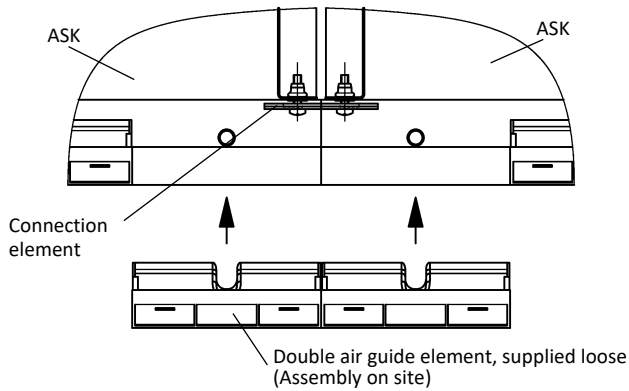

**DSXW-...-ASK with DSXW-...-BW (active – active)
DSXW-...-ASK with DSXW-...-BS (active – passive)**

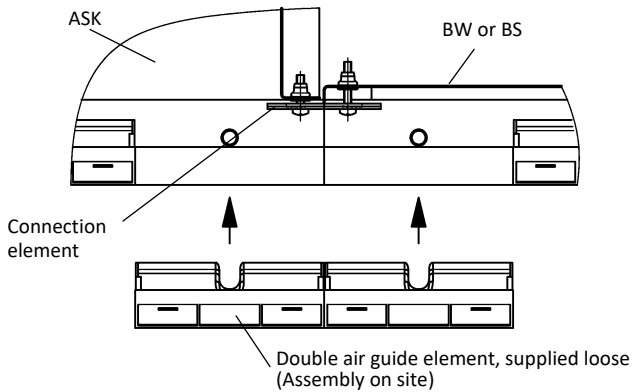

**DSXW-...-BW with DSXW-...-BW (active – active)
DSXW-...-BW with DSXW-...-BS (active – passive)
DSXW-...-BS with DSXW-...-BS (passive – passive)**

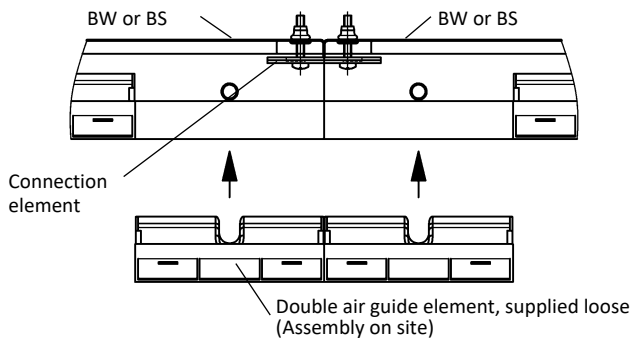

Connection element for the connection between:

DSXW-...-ASK with DSXW-...-ASK	active - active
DSXW-...-ASK with DSXW-...-BW	active - active
DSXW-...-ASK with DSXW-...-BS	active - passive
DSXW-...-BW with DSXW-...-BW	active - active
DSXW-...-BW with DSXW-...-BS	active - passive
DSXW-...-BS with DSXW-...-BS	passive - passive

Detail of connection element

(only for active - passive design and passive - passive design)



Mounting handle for air guide element

Air guide element (standard)

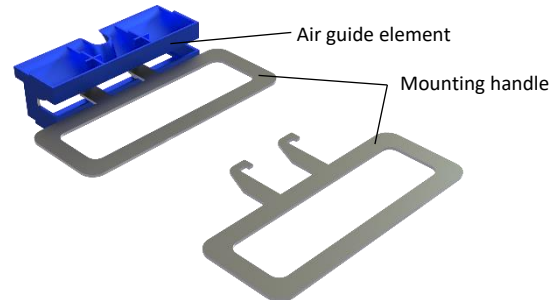

Double air guide element (for band design)

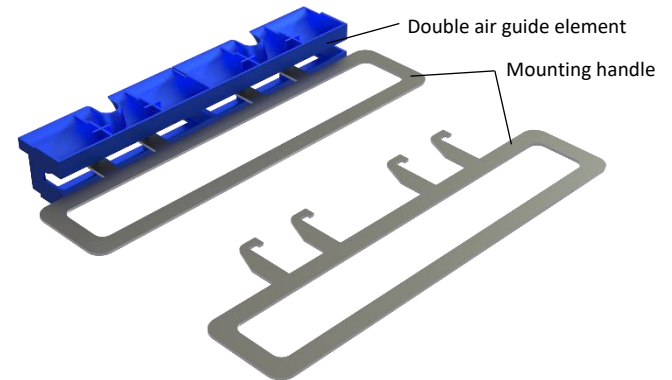

Rubber lip seal (-GD0/-GD1), for ASK-23

- without rubber lip seal (-GD0) (standard).
- with rubber lip seal (-GD1), made of special rubber.

Detail Y

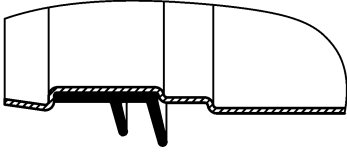

Damper (-DK0/-DK2), for ASK-23

- without damper (-DK0) (standard).
- with damper and cable-operated adjustment (-DK2) (in connection spigot).

DK2 (with cable-operated adjustment):

- lateral spigot (-S1)

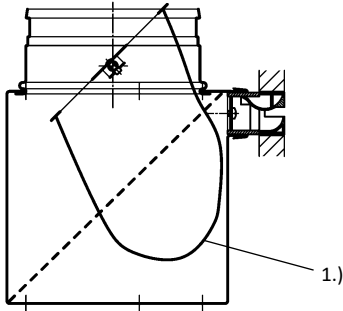

- spigot from above (-S0, standard)

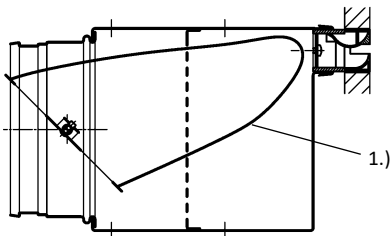

- lateral spigot located on the opposite side (-S2)

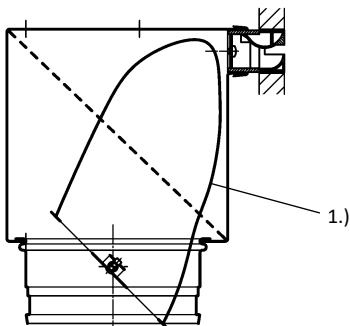

1.) With cable-operated adjustment (SZV)

Insulation (-I0 / -li / -Ia), for ASK-23

- without insulation (-I0) (standard).
- with internal insulation (-li).
- with external insulation (-Ia).

Internal insulation (-li)

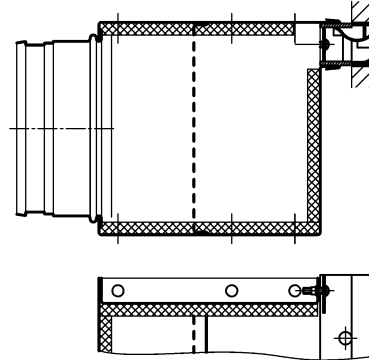

External insulation (-Ia)

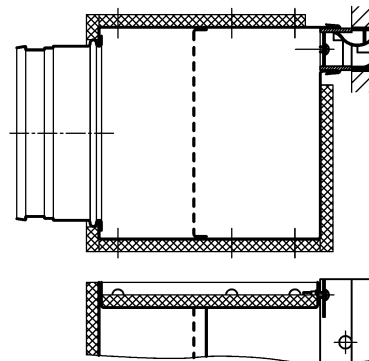

MOUNTING

Without connection (-00)

- Slot diffuser and plenum box are **not** connected to one another.
- Standard with dummy piece (-BS) and with mounting bracket (-BW).

Concealed mounting with plenum box (-VM)

- Slot diffuser and plenum box are connected to one another ex works.
- The slot diffuser is screwed to the plenum box housing (face part) with concealed screws.

DSXW-1-...

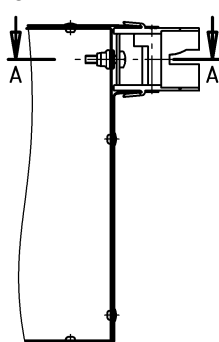

DSXW-2-... to DSXW-4-...

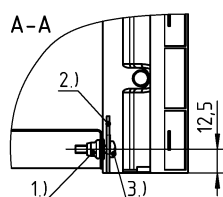
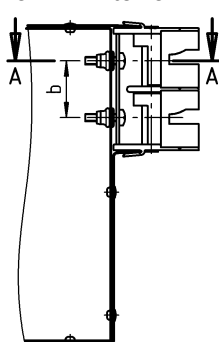

	b
DSXW-1	-
DSXW-2	30
DSXW-3	62
DSXW-4	93

Number of fastening screws:

DSXW-1-... with 2 screws

DSXW-2-... to DSXW-4-... with 4 screws

- 1.) Riveting nut M4
- 2.) Connecting plate
- 3.) Torx screw M4 DIN 7991-TX

Suspension via fastening holes

- for model:
 - dummy piece (-BS1)
 - mounting bracket (-BW, pair)
- Only possible without plenum box.
- The slot diffuser is fastened to 4 suspension brackets.

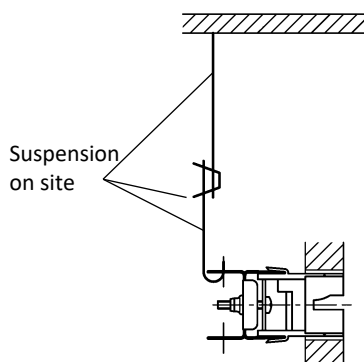

Clamp strap (-KB)

- for room side installation in finished pressure ceilings.
- Only possible without plenum box.
- Screws and clamp straps are supplied loose (pair).
- possible for the models DSXW-...-P0 and DSXW-...-PB. (not possible for model DSXW-...-S0)
- the slot diffuser is screwed to the clamp strap with concealed screws (included in delivery).
- **for mounting, access on the rear is not required!**

In mounting position

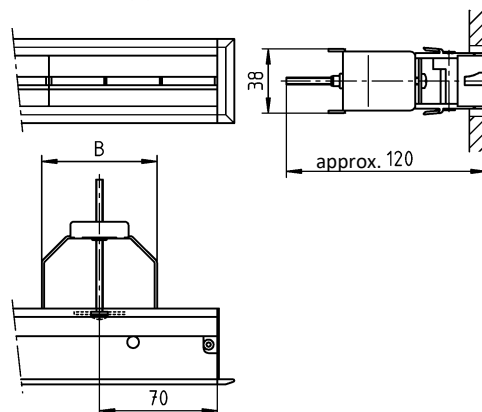

In clamping position

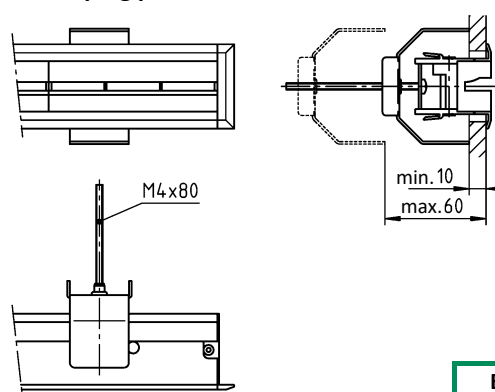

Detail of clamp strap

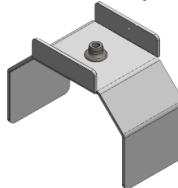

	B
DSXW-1-...-P0	69
DSXW-1-...-PB	100
DSXW-2-...-P0	132
DSXW-2-...-PB	163
DSXW-3-...-P0	132
DSXW-3-...-PB	163
DSXW-4-...-P0	163
DSXW-4-...-PB	163

Mounting instructions

As standard, the clamp straps are delivered loose.

1. Take out the air guide elements at the ends.
2. Fasten the clamp strap with the screw such that it is positioned in the direction of the slot diffuser (see installation position).
3. Then introduce the slot diffuser into the wall.
4. Then rotate the clamp strap by about 90° by rotating the screw and lower it over the slot diffuser profile (see clamping position).
5. Tighten the screw until the slot diffuser is firmly locked at the wall.
6. Finally, re-insert the air guide elements.

TYPE OF INSTALLATION

Plenum box (-ASK-23) rotated

On request, the plenum box can be mounted rotated. This must be specified when ordering the plenum box.

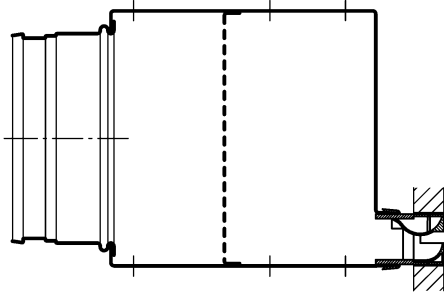

Optimum installation

The clearance between ceiling and upper edge of the diffuser must not exceed 0.5 m, otherwise no coanda effect is achieved!

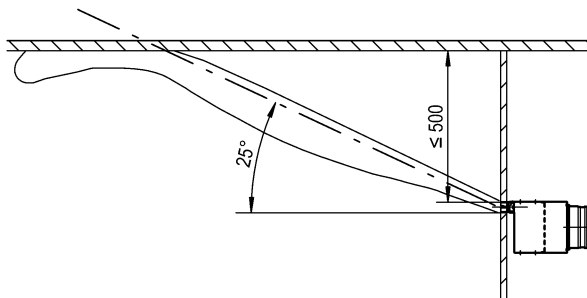

TECHNICAL DATA

Pressure loss and noise level

**DSXW-1-Z-...-ASK-23-1-...
 L=400 (1-slot, supply air, with plenum box)**

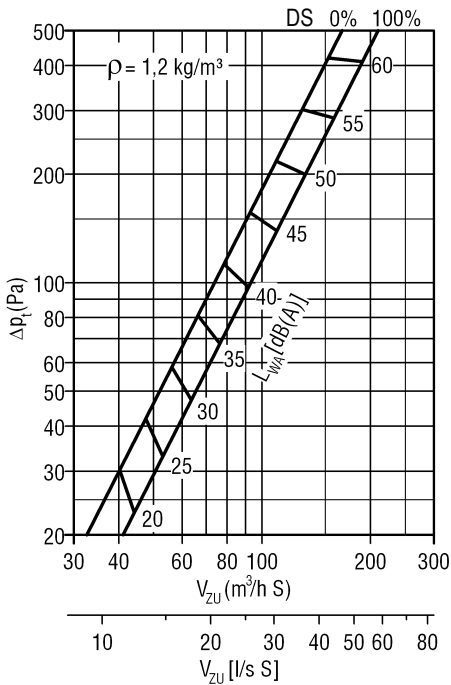

**DSXW-2-Z-...-ASK-23-2-...
 L=400 (2-slot, supply air, with plenum box)**

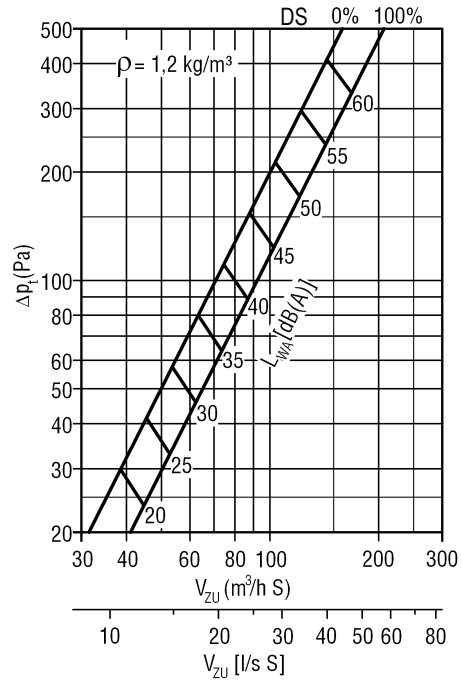

**DSXW-3-Z-...-ASK-23-3-...
 L=400 (3-slot, supply air, with plenum box)**

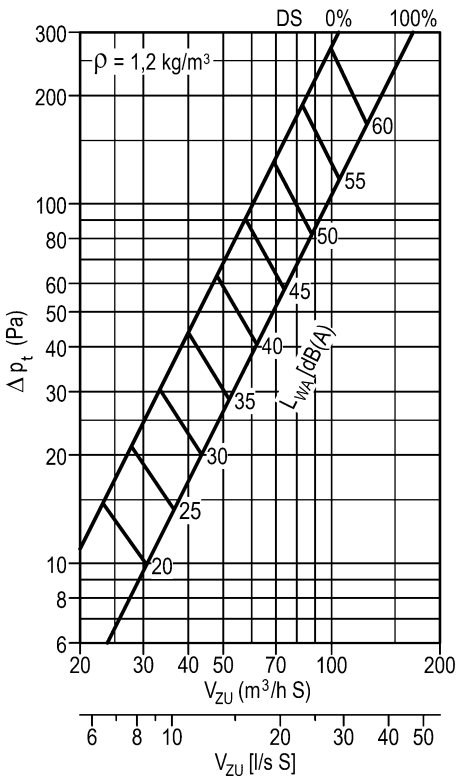

**DSXW-4-Z-...-ASK-23-4-...
 L=400 (4-slot, supply air, with plenum box)**

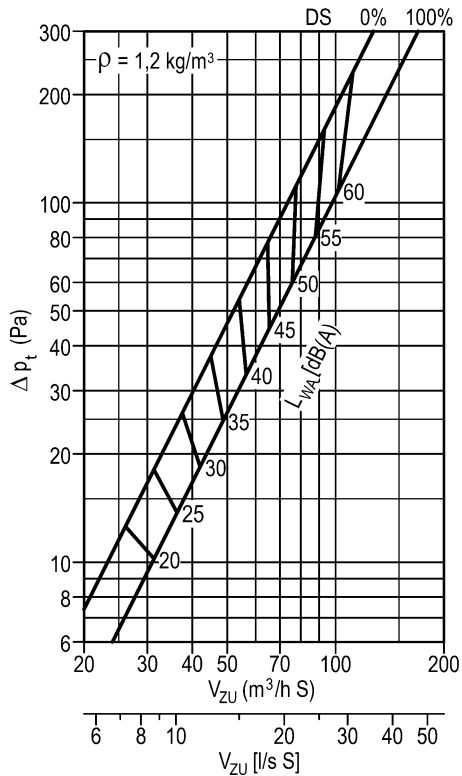

Damper position DS:

CLOSED = 0 %

OPEN = 100 %

DSXW-1-Z-...-ASK-23-1-...
L=500 (1-slot, supply air, with plenum box)

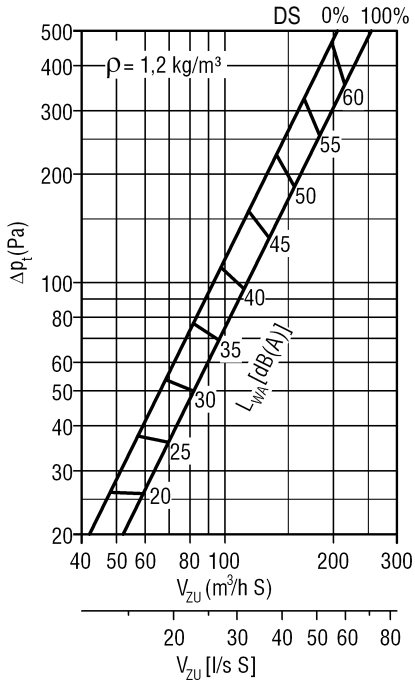

DSXW-2-Z-...-ASK-23-2-...
L=500 (2-slot, supply air, with plenum box)

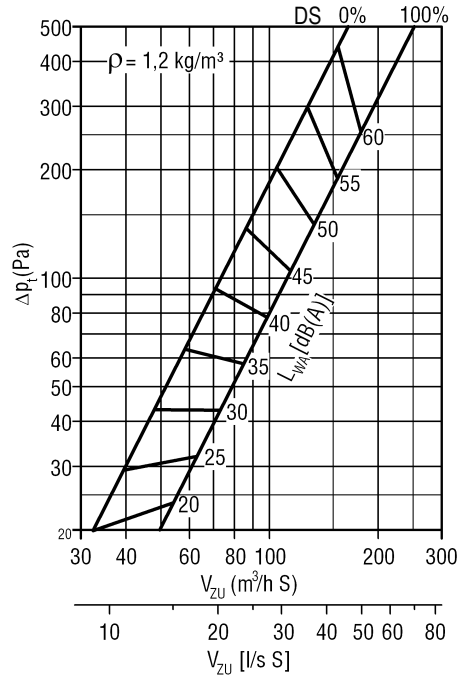

DSXW-3-Z-...-ASK-23-3-...
L=500 (3-slot, supply air, with plenum box)

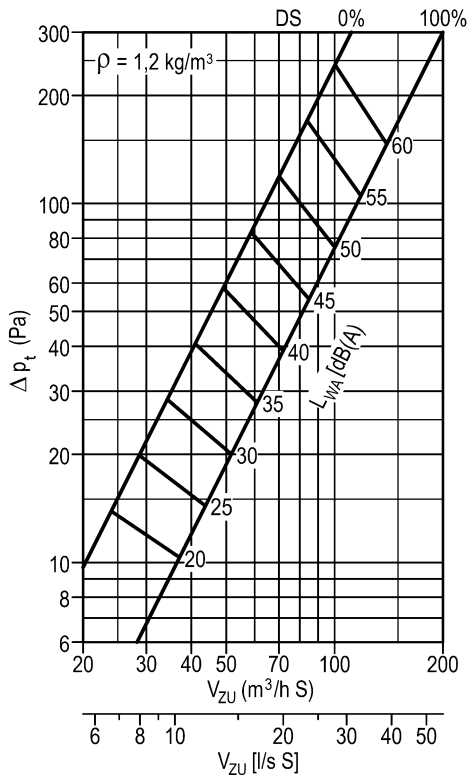

DSXW-4-Z-...-ASK-23-4-...
L=500 (4-slot, supply air, with plenum box)

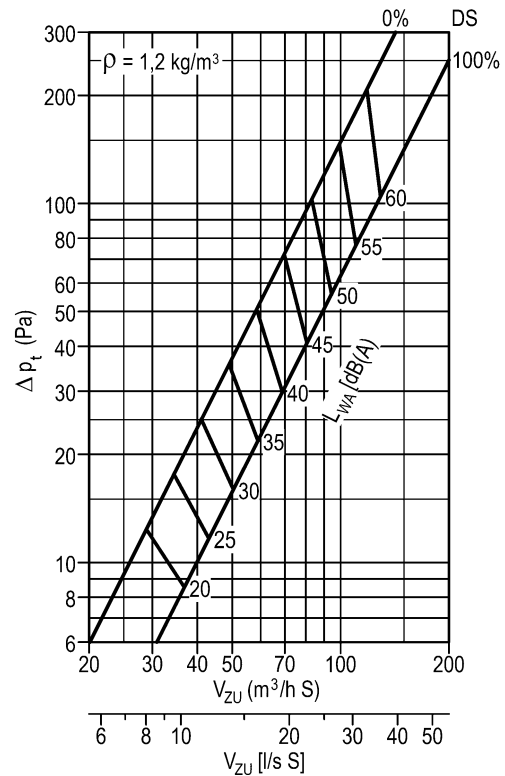

Damper position DS:
 CLOSED = 0 %
 OPEN = 100 %

DSXW-1-Z-...-ASK-23-1-...

L=600 (1-slot, supply air, with plenum box)

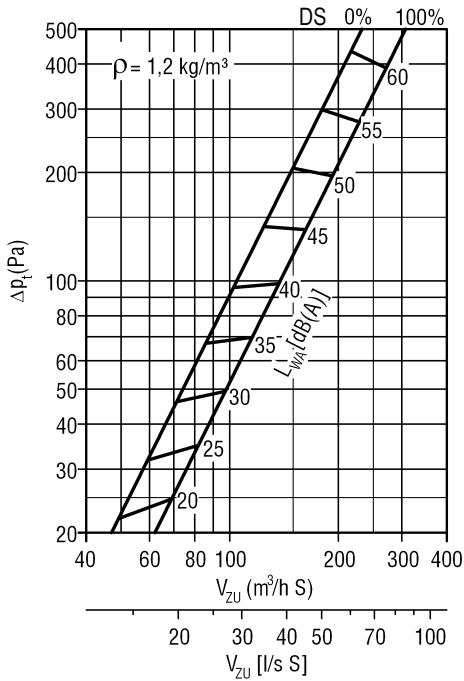

DSXW-2-Z-...-ASK-23-2-...

L=600 (2-slot, supply air, with plenum box)

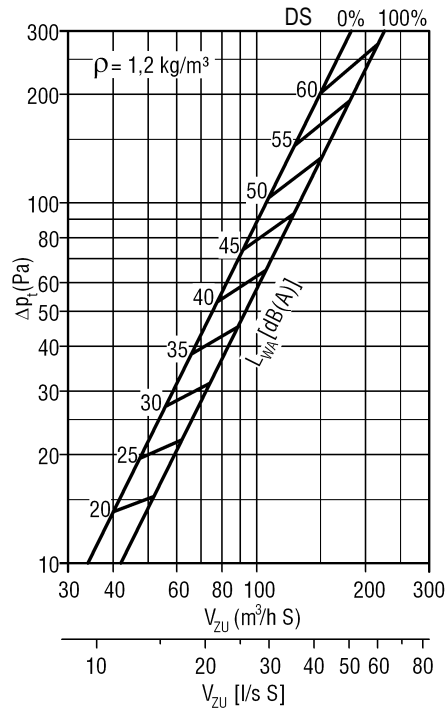

DSXW-3-Z-...-ASK-23-3-...

L=600 (3-slot, supply air, with plenum box)

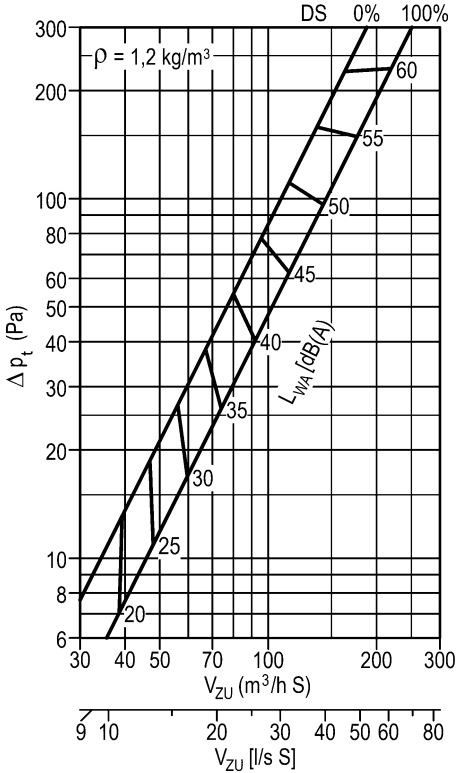

DSXW-4-Z-...-ASK-23-4-...

L=600 (4-slot, supply air, with plenum box)

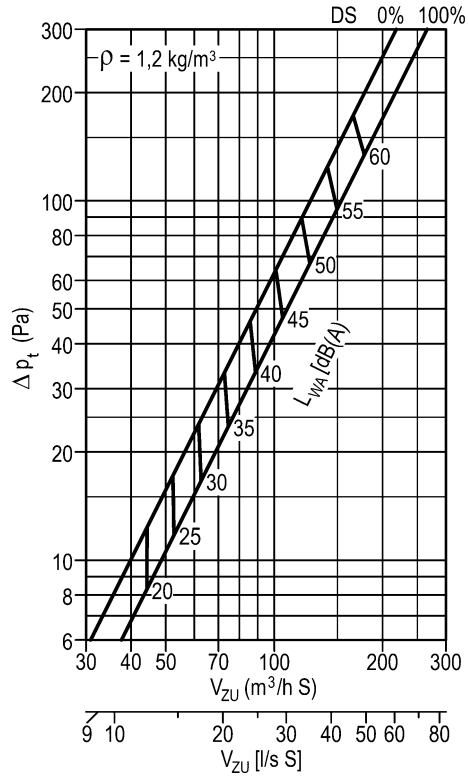

Damper position DS:

CLOSED = 0 %

OPEN = 100 %

DSXW-1-Z-...-ASK-23-1-...
L=800 (1-slot, supply air, with plenum box)

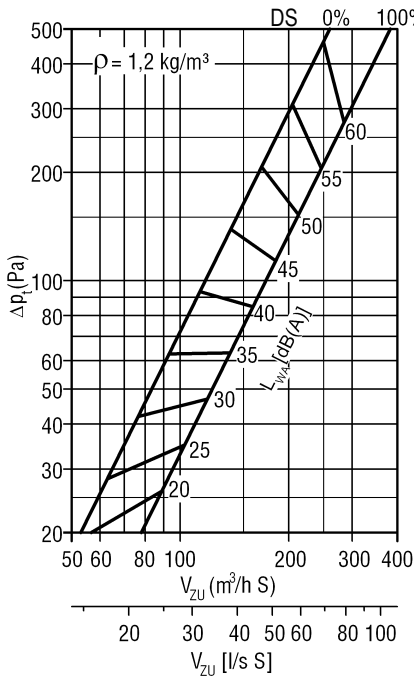

DSXW-2-Z-...-ASK-23-2-...
L=800 (2-slot, supply air, with plenum box)

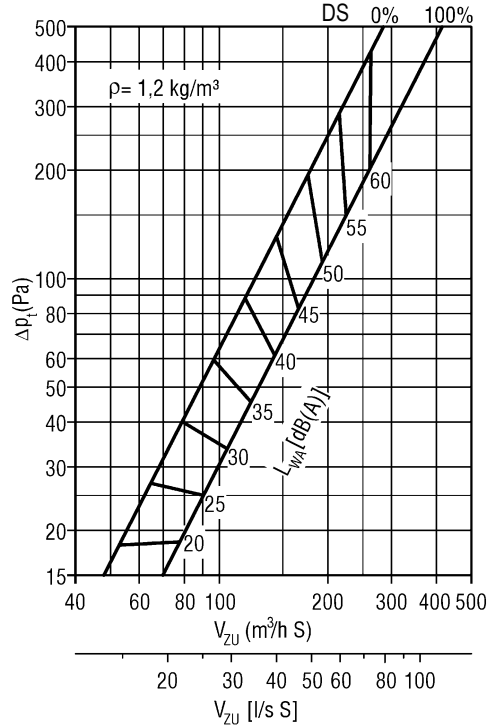

DSXW-3-Z-...-ASK-23-3-...
L=800 (3-slot, supply air, with plenum box)

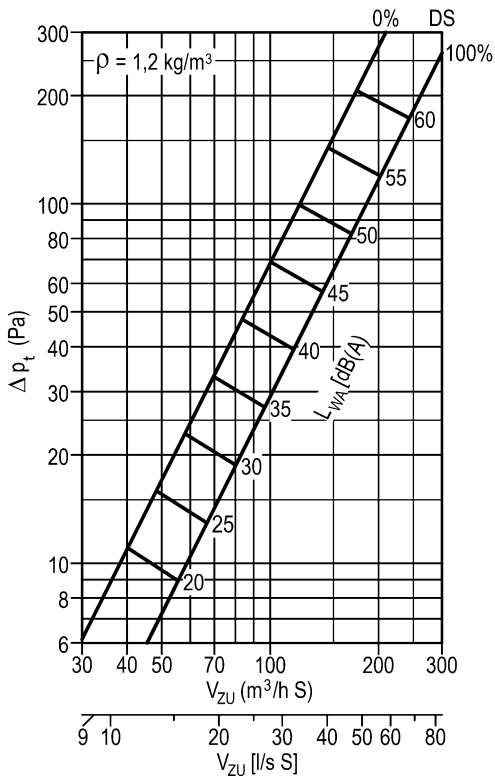

DSXW-4-Z-...-ASK-23-4-...
L=800 (4-slot, supply air, with plenum box)

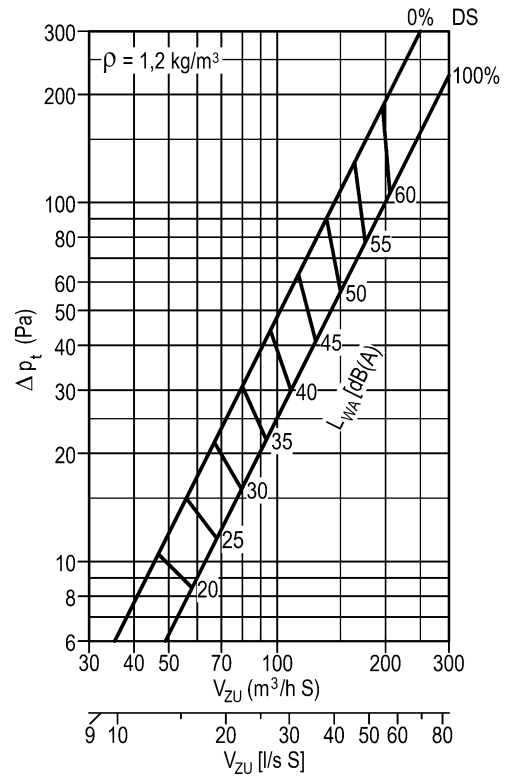

Damper position DS:
 CLOSED = 0 %
 OPEN = 100 %

DSXW-1-Z-...-ASK-23-1-...

L=1000 (1-slot, supply air, with plenum box)

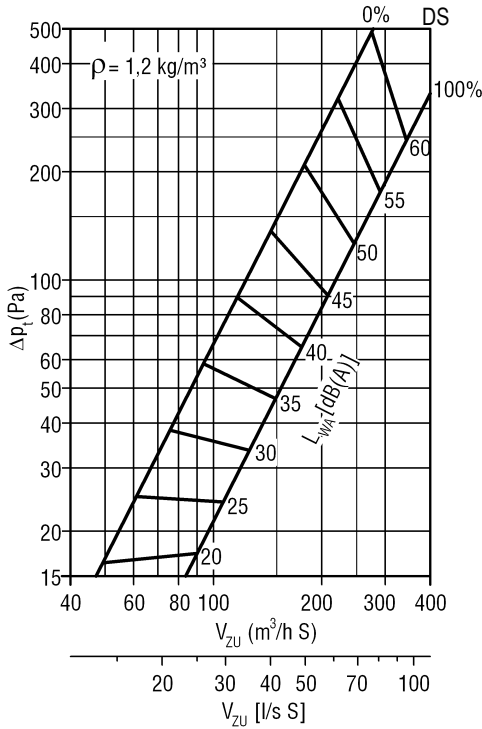

DSXW-2-Z-...-ASK-23-2-...

L=1000 (2-slot, supply air, with plenum box)

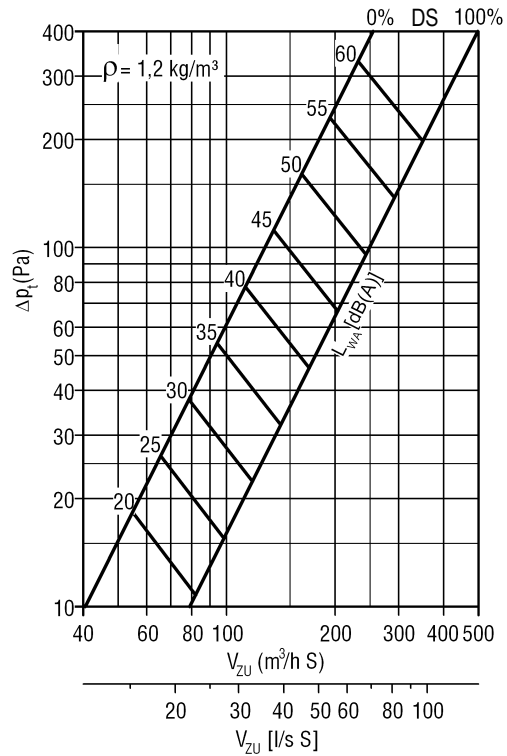

DSXW-3-Z-...-ASK-23-3-...

L=1000 (3-slot, supply air, with plenum box)

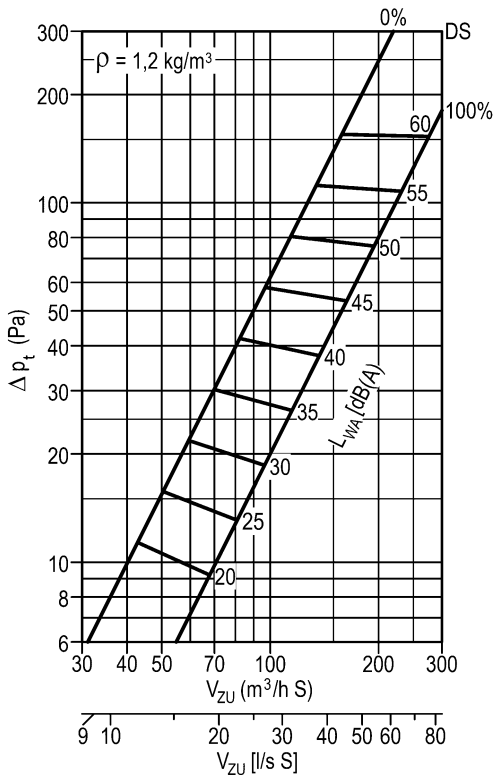

DSXW-4-Z-...-ASK-23-4-...

L=1000 (4-slot, supply air, with plenum box)

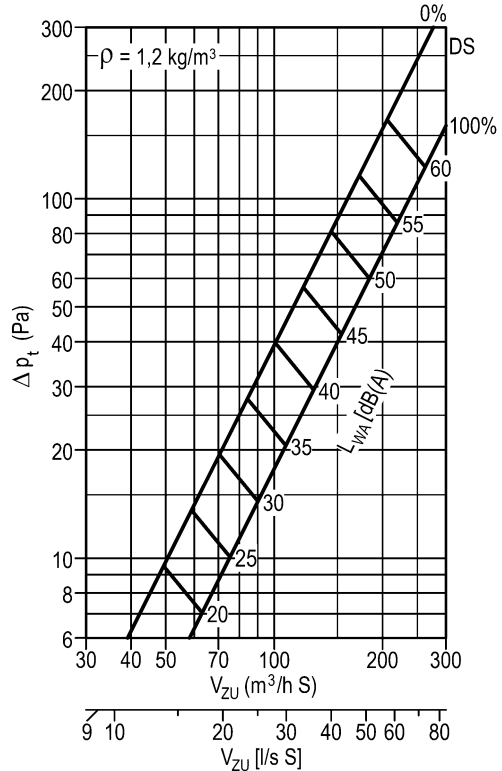

Damper position DS:

CLOSED = 0 %

OPEN = 100 %

DSXW-1-A...-ASK-23-1...
L=400 (1-slot, return air, with plenum box)

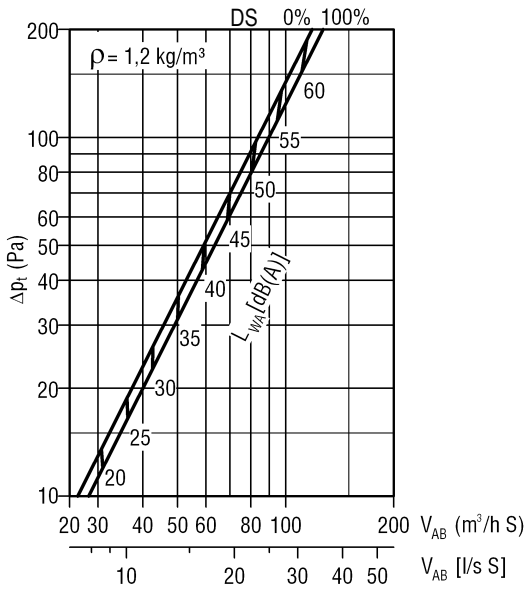

DSXW-2-A...-ASK-23-2...
L=400 (2-slot, return air, with plenum box)

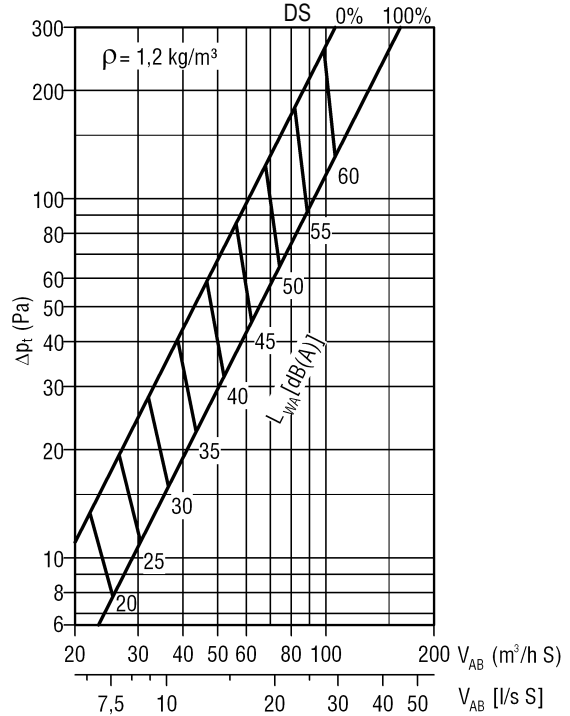

DSXW-3-A...-ASK-23-3...
L=400 (3-slot, return air, with plenum box)

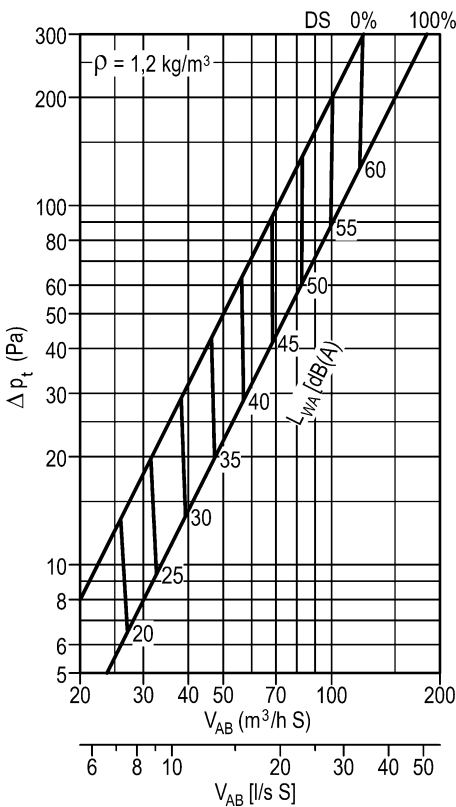

DSXW-4-A...-ASK-23-4...
L=400 (4-slot, return air, with plenum box)

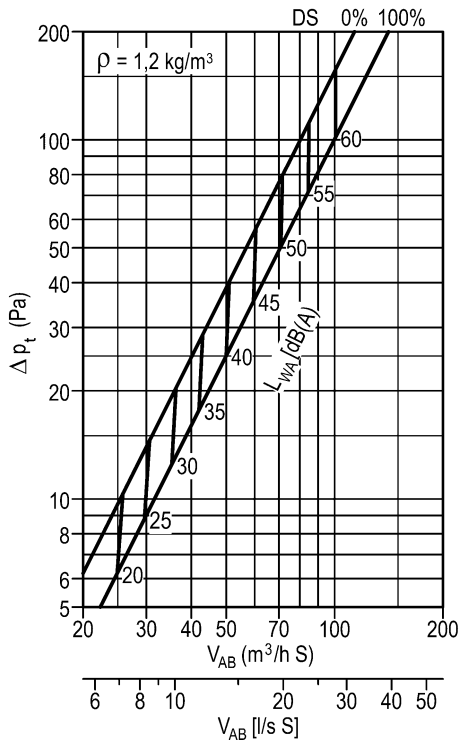

Damper position DS:
 CLOSED = 0 %
 OPEN = 100 %

DSXW-1-A...-ASK-23-1...
L=500 (1-slot, return air, with plenum box)

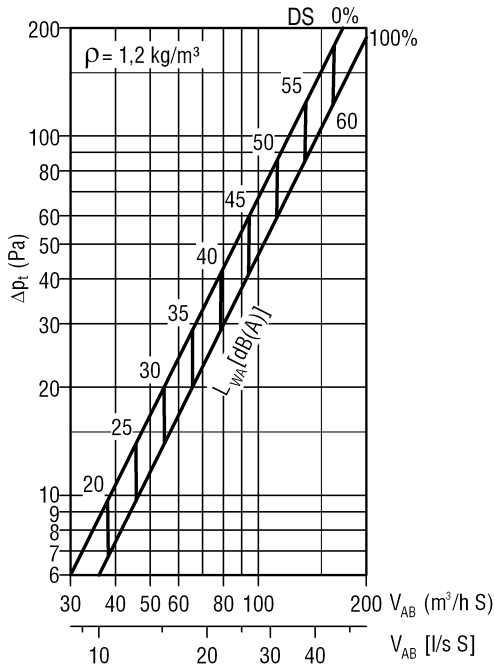

DSXW-2-A...-ASK-23-2...
L=500 (2-slot, return air, with plenum box)

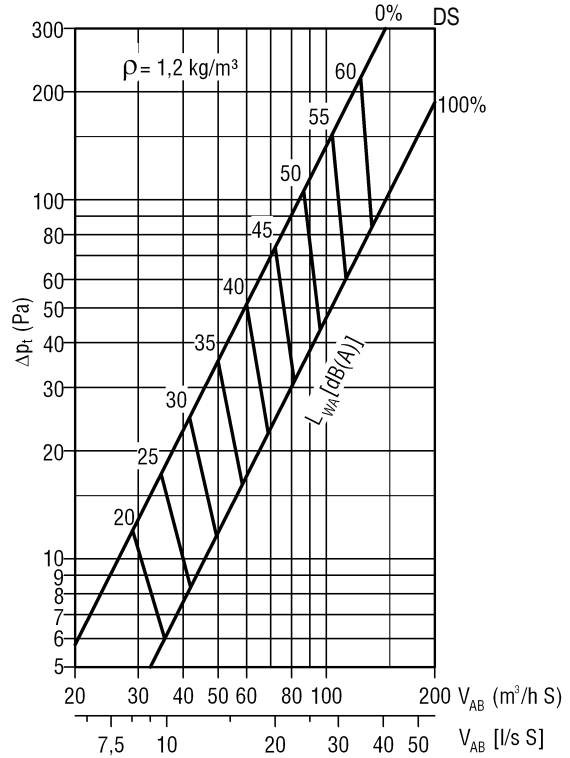

DSXW-3-A...-ASK-23-3...
L=500 (3-slot, return air, with plenum box)

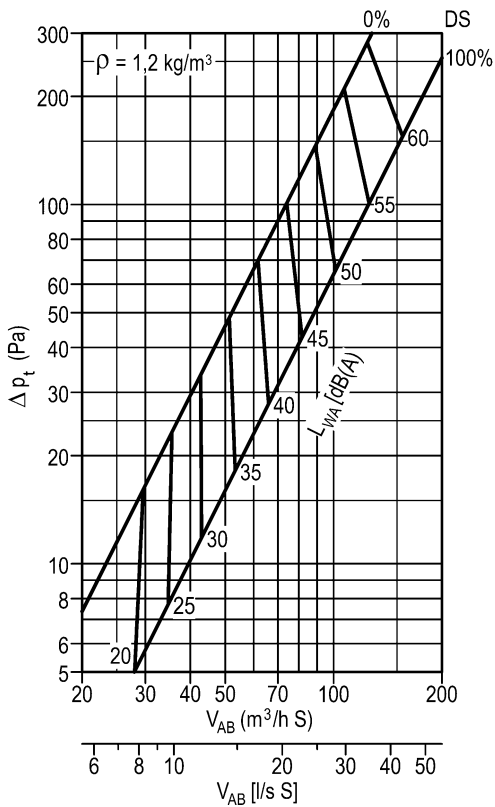

DSXW-4-A...-ASK-23-4...
L=500 (4-slot, return air, with plenum box)

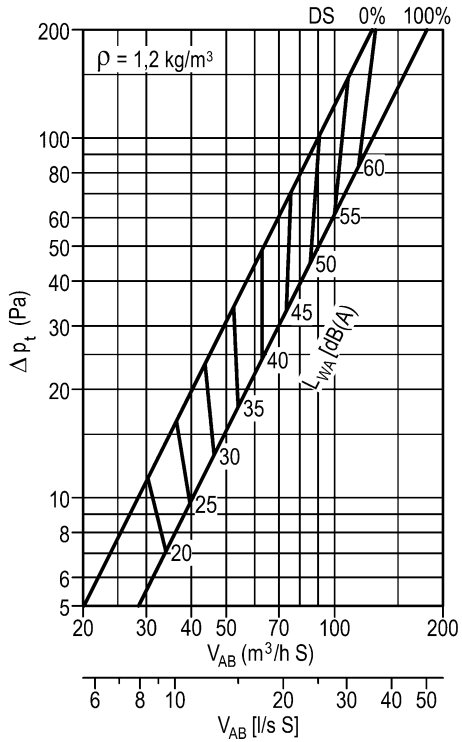

Damper position DS:
 CLOSED = 0 %
 OPEN = 100 %

DSXW-1-A...-ASK-23-1...

L=600 (1-slot, return air, with plenum box)

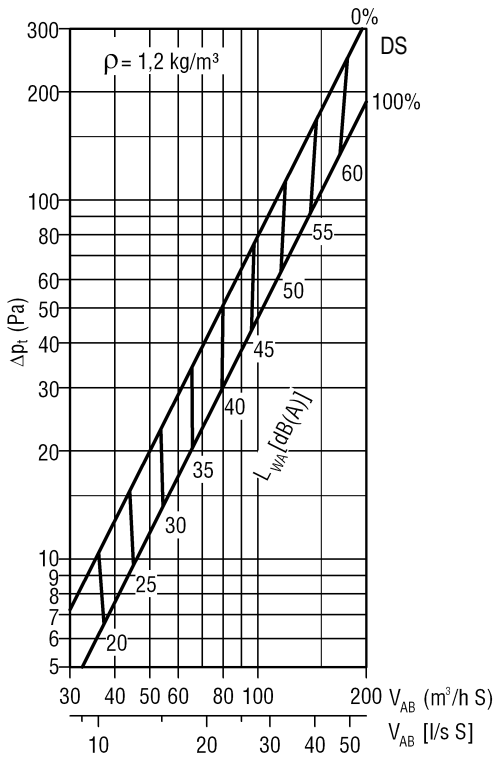

DSXW-2-A...-ASK-23-2...

L=600 (2-slot, return air, with plenum box)

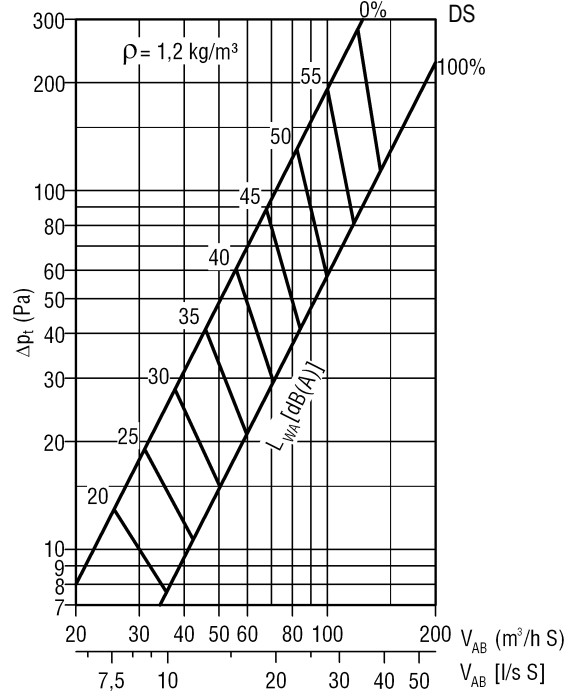

DSXW-3-A...-ASK-23-3...

L=600 (3-slot, return air, with plenum box)

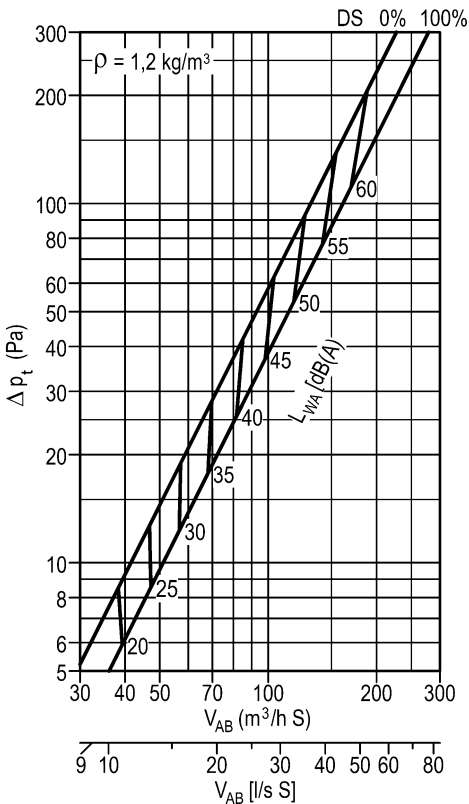

DSXW-4-A...-ASK-23-4...

L=600 (4-slot, return air, with plenum box)

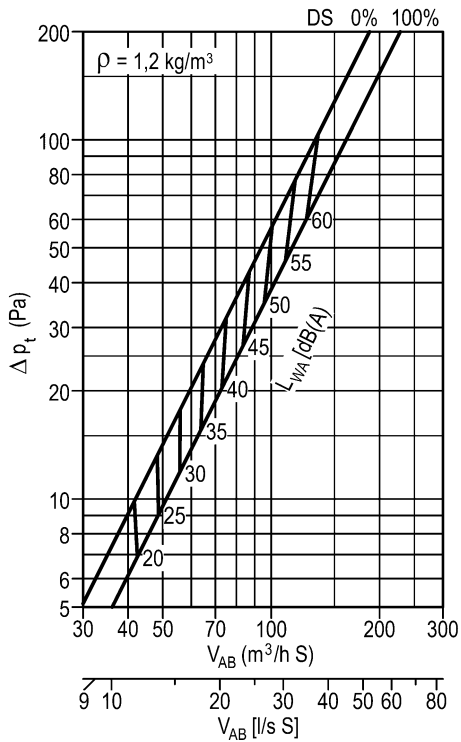

Damper position DS:

CLOSED = 0 %

OPEN = 100 %

DSXW-1-A...-ASK-23-1...
L=800 (1-slot, return air, with plenum box)

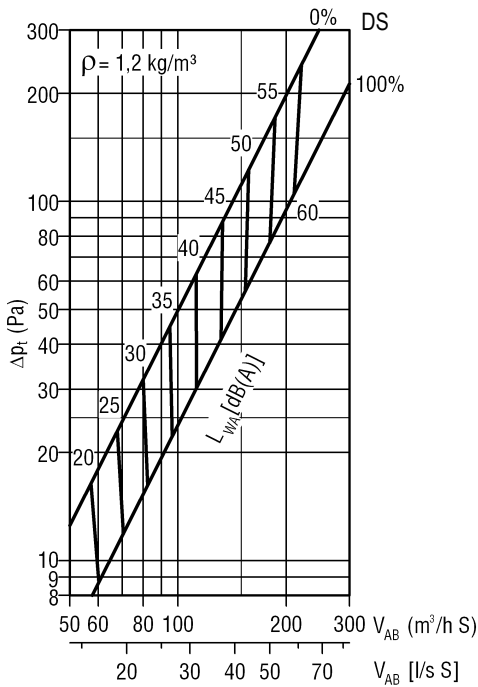

DSXW-2-A...-ASK-23-2...
L=800 (2-slot, return air, with plenum box)

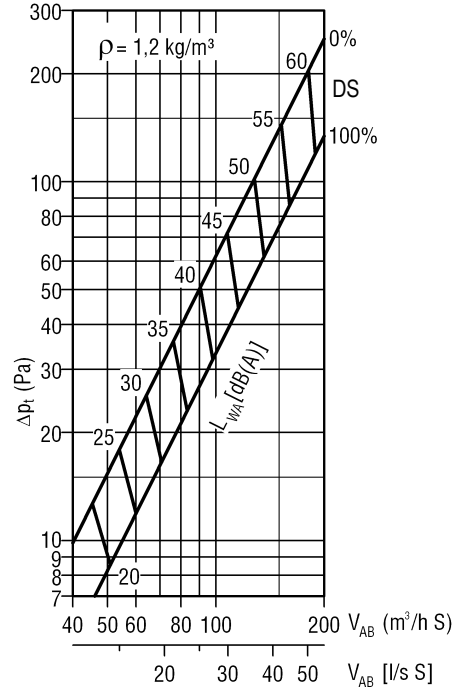

DSXW-3-A...-ASK-23-3...
L=800 (3-slot, return air, with plenum box)

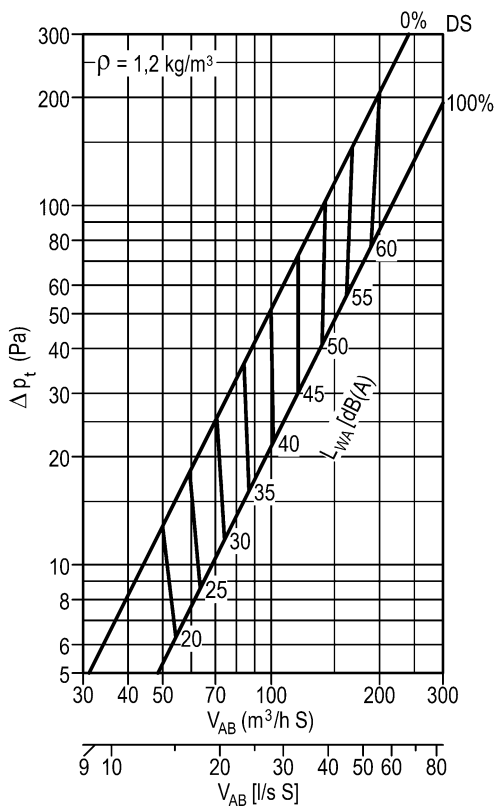

DSXW-4-A...-ASK-23-4...
L=800 (4-slot, return air, with plenum box)

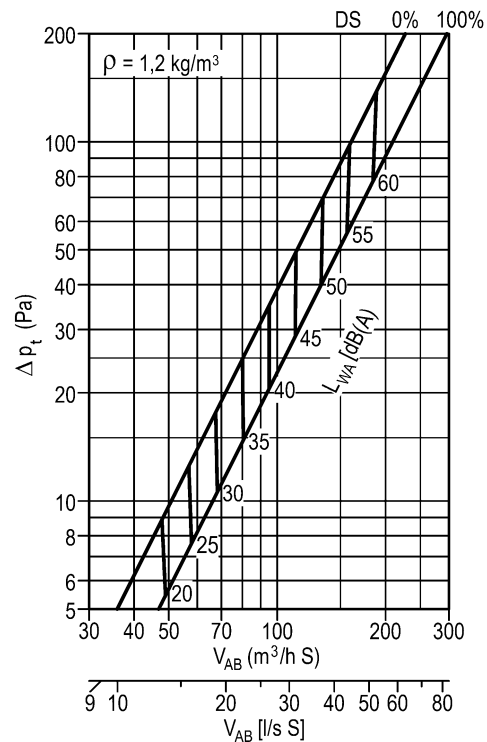

Damper position DS:
 CLOSED = 0 %
 OPEN = 100 %

DSXW-1-A...-ASK-23-1...

L=1000 (1-slot, return air, with plenum box)

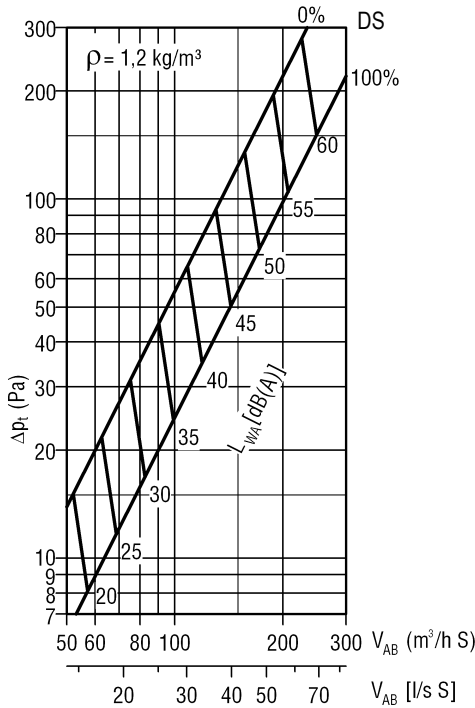

DSXW-2-A...-ASK-23-2...

L=1000 (2-slot, return air, with plenum box)

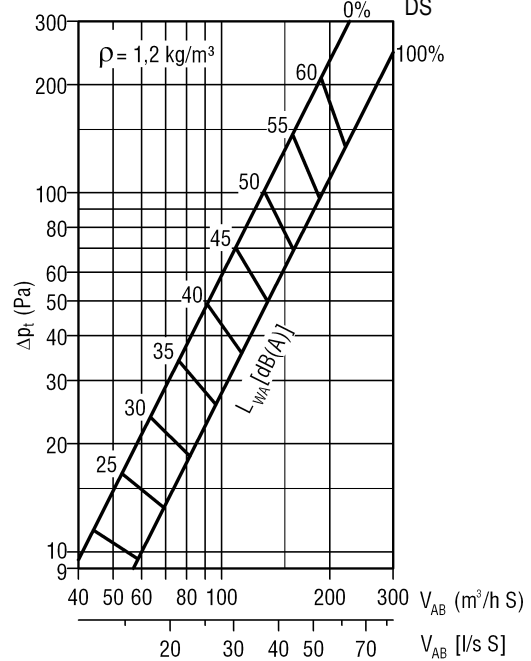

DSXW-3-A...-ASK-23-3...

L=1000 (3-slot, return air, with plenum box)

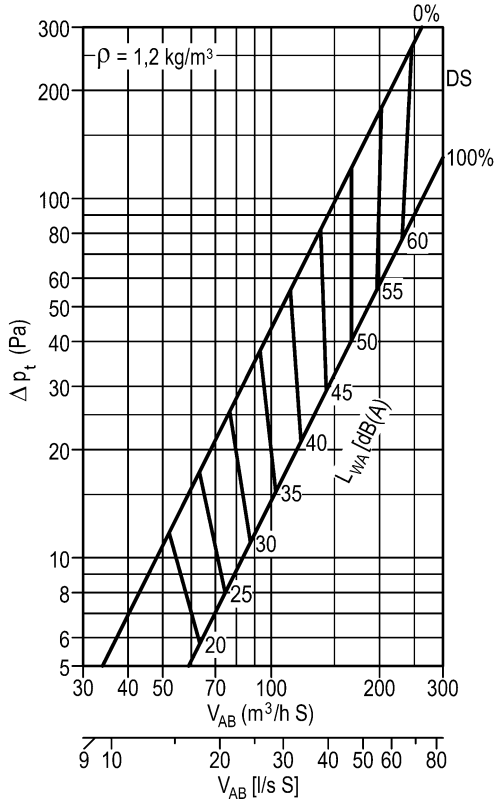

DSXW-4-A...-ASK-23-4...

L=1000 (4-slot, return air, with plenum box)

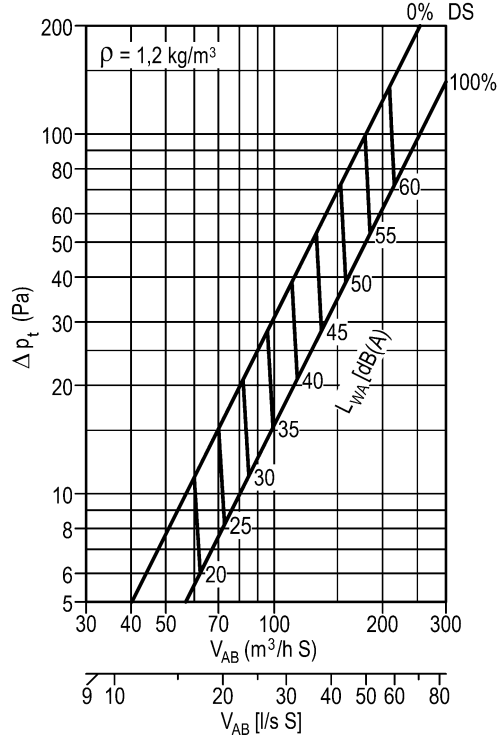

Damper position DS:

CLOSED = 0 %

OPEN = 100 %

Maximum final jet velocity

DSXW-1-...-0400-... / L=400

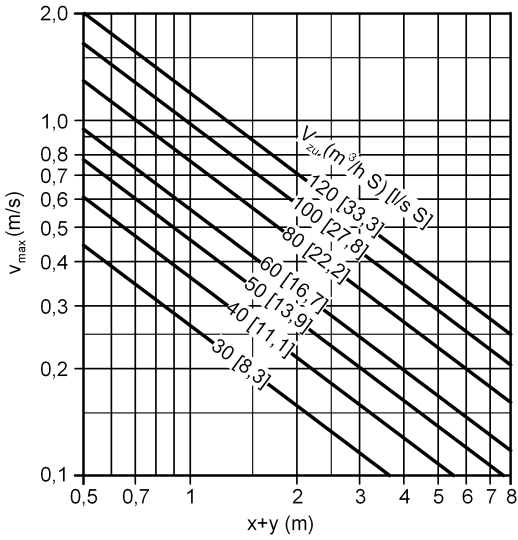

DSXW-1-...-0800-... / L=800

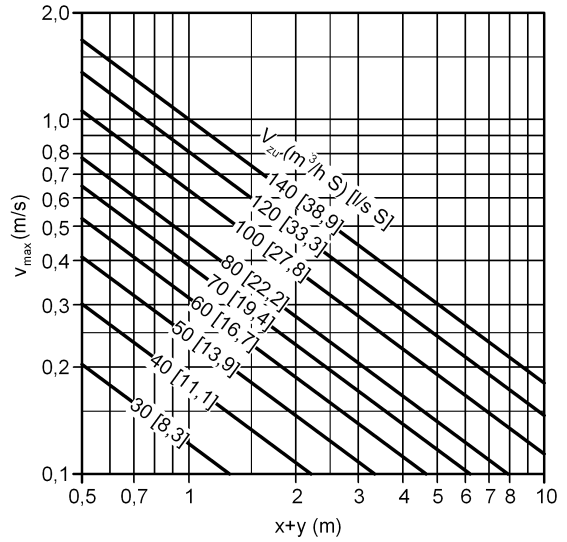

DSXW-1-...-0500-... / L=500

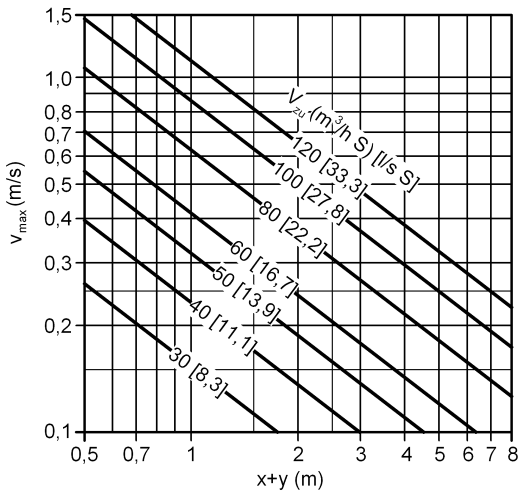

DSXW-1-...-1000-... / L=1000

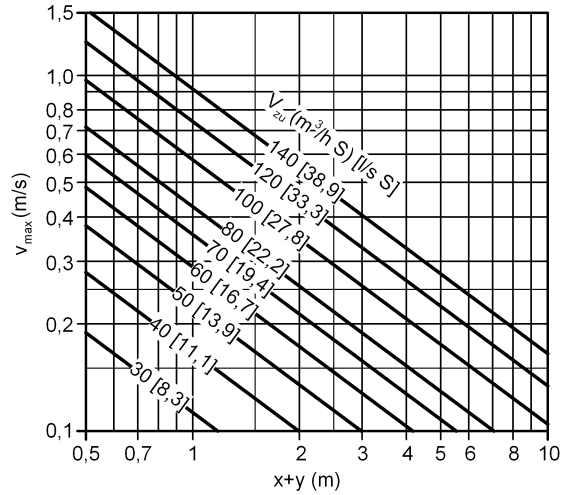

DSXW-1-...-0600-... / L=600

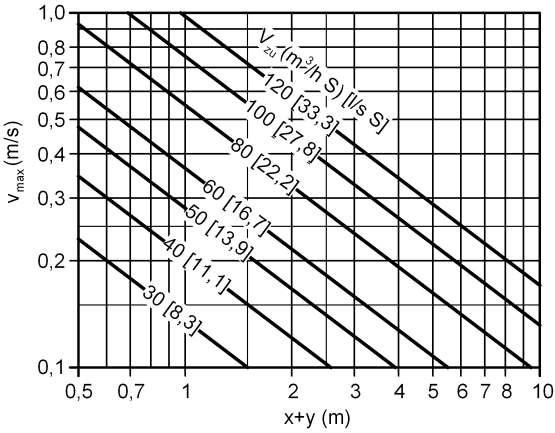

Correction factor

DSXW-2-... : $v_{max} \times 1.33 / V_{zu} \times 2$

DSXW-3-... : $v_{max} \times 1.51 / V_{zu} \times 3$

DSXW-4-... : $v_{max} \times 1.72 / V_{zu} \times 4$

Critical throw

Calculation of the maximum throw distance in cooling mode

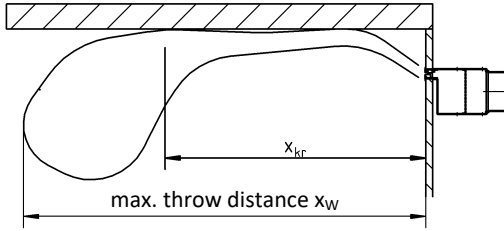

$x_w = x_{kr} \times 2.66$

DSXW-1-...-0400-... / L=400

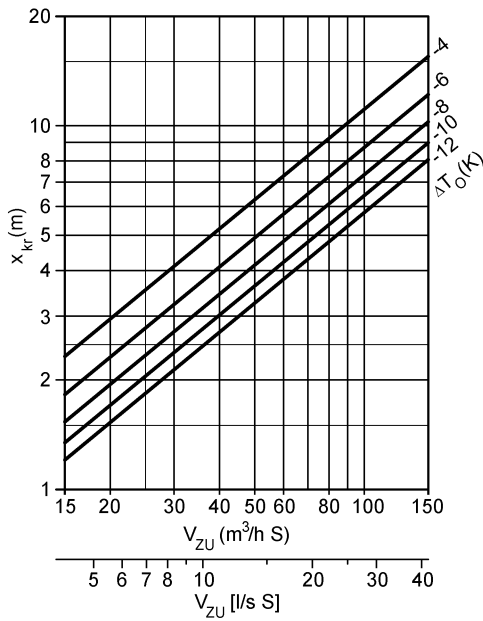

DSXW-1-...-0500-... / L=500

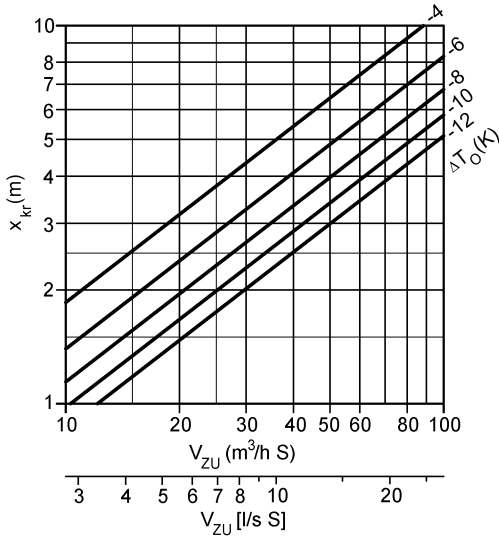

DSXW-1-...-0600-... / L=600

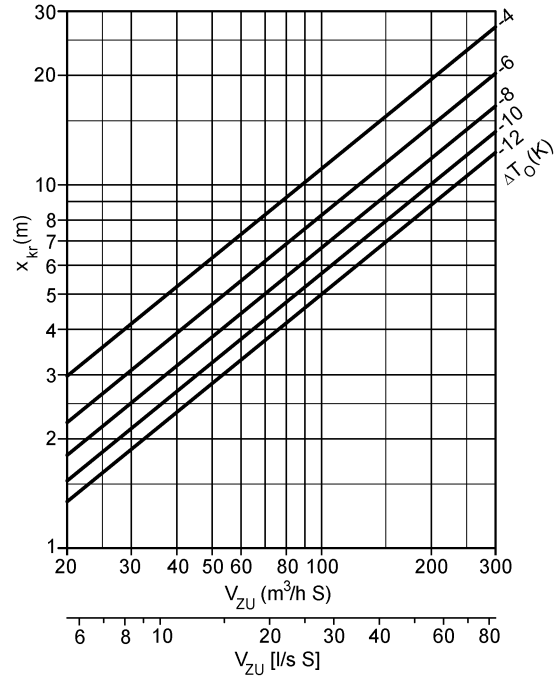

DSXW-1-...-0800-... / L=800

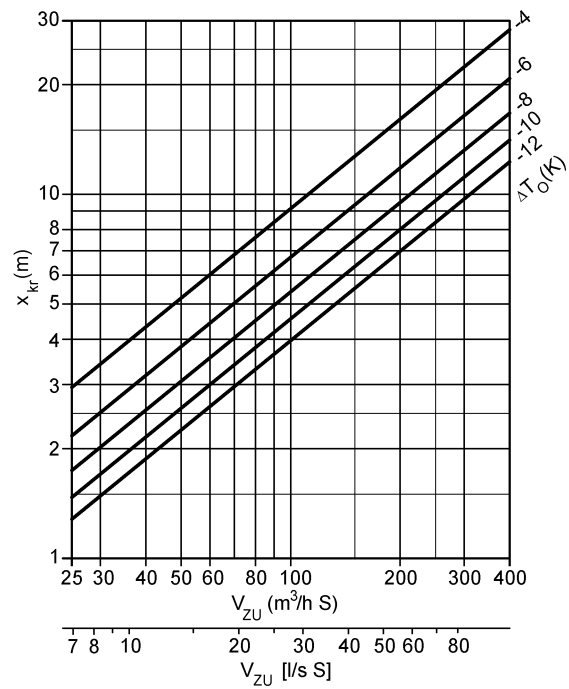

DSXW-1-...-1000-... / L=1000

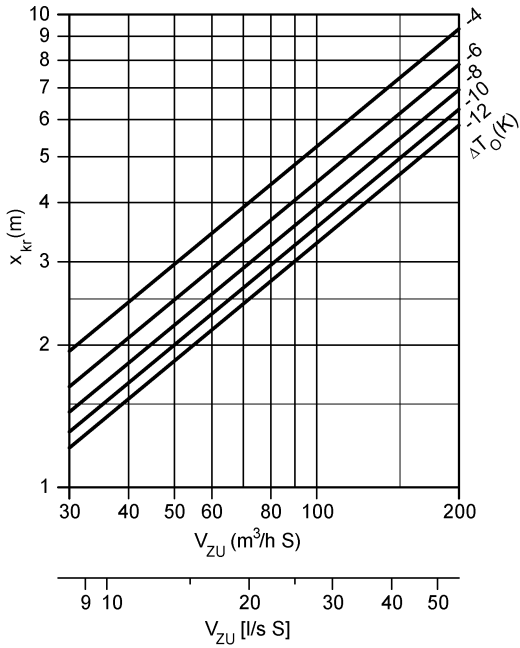

Correction factor

DSXW-2-... : $x_{kr} \times 1.17 / V_{ZU} \times 2$

DSXW-3-... : $x_{kr} \times 1.35 / V_{ZU} \times 3$

DSXW-4-... : $x_{kr} \times 1.75 / V_{ZU} \times 4$

Induction ratio and temperature ratios

DSXW-1-...

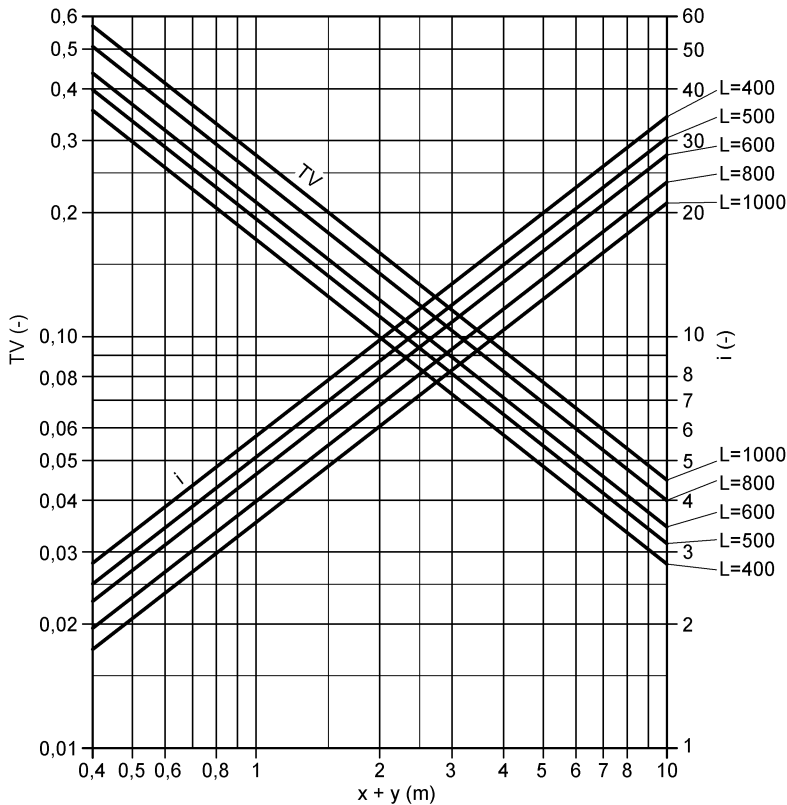

Correction factor for induction ratios

DSXW-2-... : $i \times 0.711$

DSXW-3-... : $i \times 0.740$

DSXW-4-... : $i \times 0.501$

Correction factor for temperature ratios

DSXW-2-... : $TV \times 1.38$

DSXW-3-... : $TV \times 1.32$

DSXW-4-... : $TV \times 1.91$

LEGEND

V_{ZU}	(m ³ /h S)	= Supply air volumetric flow per slot
V_{ZU}	[l/s S]	= Supply air volumetric flow per slot
V_{AB}	(m ³ /h m S)	= Return air volumetric flow per slot
V_{AB}	[l/s m S]	= Return air volumetric flow per slot
V_X	(m ³ /h m S)	= total air jet volume at point x
V_X	[l/s m S]	= total air jet volume at point x
Δp_t	(Pa)	= pressure loss
ρ	(kg/m ³)	= Density
L_{WA}	[dB(A)]	= A-weighted sound power level ($L_{WA} - L_{WA1} + KF$)
L_{WA1}	[dB(A)]	= A-weighted sound power level, relative to L = 1000
x_{kr}	(m)	= critical throw
x_w	(m)	= maximum throw distance
ΔT_O	(K)	= Temperature difference between supply air and room temperature ($\Delta T_O = t_{ZU} - t_R$)
ΔT_x	(K)	= temperature difference at point x
v_{max}	(m/s)	= max. end velocity of jet
TV	(-)	= temperature ratio (TV = $\Delta T_x / \Delta T_O$)
i	(-)	= induction ratio (i = V_x / V_{ZU})
x+y	(m)	= horizontal + vertical throw
x	(m)	= horizontal throw
y	(m)	= vertical throw
t_{ZU}	(°C)	= supply air temperature
t_R	(°C)	= room temperature
KF	(-)	= Correction factor
KL	(mm)	= Length of box
KB	(mm)	= Width of box
KHS	(mm)	= Height of plenum box
GH	(mm)	= total height
L	(mm)	= length

SLOT DIFFUSER ORDER CODE

01	02	03	04	05	06
Type	Model	Air throw	Frame profile	Frame surface	Blade colour
Example					
DSXW	-2	-Z	-S0	-9010	-L9005

07	08	09	10	11	12
Blade position for air jet	Single / band design	Length	Mounting	End piece	Mounting bracket / dummy piece
-L	-N	-01000	-VM	-ES	-B0

Sample

DSXW-2-Z-S0-9010-L9005-L-N-01000-VM-ES-B0

Wall slot diffusers DSXW | 2-slot | Supply air | narrow frame profile, without support profile, for invisible installation | Aluminium painted to RAL colour 9010 (white) | Air guide element made of plastic material, similar to RAL 9005 (black) | Air guide element with horizontal one-way throw diagonally upwards | Single design | Length L = 1000 mm | Concealed mounting | With end piece | Without mounting bracket / without mounting bracket and without dummy piece

ORDER DETAILS

01 - Type

DSXW = Wall slot diffuser DSXW

02 - Model

- 1 = 1-slot.
- 2 = 2-slot.
- 3 = 3-slot.
- 4 = 4-slot.

03 - Air throw

- Z = supply air
- A = return air (with air guide elements)

04 - Frame profile

- S0 = Narrow frame profile, without support profile, for invisible installation (standard, in same colour as blade colour).
- P0 = Frame profile P0, with support profile, for visible installation.
- PB = Frame profile PB, with support profile, for visible installation.

05 - Frame surface

- ELOX = Natural colour anodised aluminium (standard for DSXW-...-P0 and DSXW-...-PB).
 - 9005 = aluminium painted to RAL colour 9005 (black).
 - 9010 = Aluminium painted to RAL colour 9010 (white).
 - xxxx = aluminium painted to a freely selectable RAL colour (at an extra charge, always with 4 digits).
- (Painted aluminium, standard for model DSX-...-S0.)

06 - Blade colour (air guide element)

- L9005 = Air guide element made of plastic, similar to RAL colour 9005 (black) (standard).
- L9010 = Air guide element made of plastic similar to RAL 9010 (white).

07 - Blade position for air jet

- L = Air guide element with horizontal one-way throw diagonally upwards (standard).

08 - Single / band design

- N = single design (length max. 1500 mm).
 - B = Band design (available lengths according to SCHAKO standard for band design, single element length max. 1500 mm).
- To lock the slot diffusers, double air guide elements are used at the butt joints (supplied loose, installation on site).

09 - Length

- 01000 = length L = 1000 mm.
 - 01500 = length L = 1500 mm.
 - xxxxx = length (L/BL) in mm, freely selectable (always with 5 digits).
- (Can be fitted with a plenum box in case of single design lengths L = ≥400 mm to ≤1500 mm.)

10 - Mounting

- 00 = without connection (not connected to the plenum box, standard for BS and BW).
- VM = concealed mounting (standard, connected to the plenum box ex works).
- KB = clamp strap (not for use with plenum box), screws and clamp strap supplied loose (pair), only possible for DSXW-...-P0 and DSXW-...-PB.

11 - End piece

- E0 = without end piece (standard).
- ES = with end piece (pair, supplied loose).
- EB = with end piece mounted ex works on both sides.
- EL = with end piece mounted ex works on the left side.
- ER = with end piece mounted ex works on the right side.

12 - Mounting bracket / dummy piece

- B0 = without mounting bracket / without dummy piece.
- BW = with mounting bracket made of galvanised sheet steel, for overflow operation (only possible without plenum box, possible from length L ≥ 200 mm). Mounting through suspension via fastening holes.
- BS = with dummy piece, made of sheet steel (only possible without plenum box, possible from length L ≥ 200 mm). Mounting through suspension via fastening holes.

With models -BW and -BS as a band, additional connecting fishplates are supplied loose.

PLENUM BOX ORDER CODE

01	02	03	04	05	06	07	08
Type	Diffuser	Model	Single / band design	Length	Mounting of box	Material	Damper
Example							
ASK	-23	-2	N	-01000	-VM	-SV	-DK2

09	10	11	12	13	14	15
Rubber lip seal	Insulation	Height of plenum box	Box neck	Spigot position	Spigot diameter	Suspension
-GD1	-I0	-KHS	-KVS	-S1	-SDS	-E0

Sample

ASK-23-2-N-01000-VM-SV-DK2-GD1-I0-KHS-KVS-S1-SDS-E0

Plenum box for slot diffuser | For DSXW | 2-slot | Single design | Length 1000 mm | Concealed mounting | Galvanised sheet steel | With damper and cable-operated adjustment | With rubber lip seal | Without insulation | Standard height of box | Standard box neck | Lateral spigot | Standard spigot diameter | Without riveting nut

ORDER DETAILS

01 - Type

ASK = plenum box for slot diffuser (rectangular design)

02 - Diffuser

23 = for DSXW (air diffuser must always be ordered separately)

03 - Model

1 = 1-slot.
2 = 2-slot.
3 = 3-slot.
4 = 4-slot.

04 - Single / band design

N = single design (length of box max. 1500 mm).
B = band design (available lengths according to SCHAKO standard for band design).

05 - Length

01000 = length L = 1000 mm.
01500 = length L = 1500 mm.
xxxxx = length (L/BL) in mm, freely selectable (always with 5 digits).
(Length of box KL = L-5 / total length of box GKL = BL-5, length min. 400 mm / max. 1500 mm).

06 - Mounting of box

00 = without connection (not connected to the slot diffuser, screws supplied loose).
VM = concealed mounting (standard, connected to the slot diffuser ex works).

07 - Material

SV = galvanised sheet steel (standard)

08 - Damper

DK0 = without damper (standard)
DK2 = With damper and cable-operated adjustment (SZV) (in connection spigot)

09 - Rubber lip seal

GD0 = without rubber lip seal (standard).
GD1 = with rubber lip seal.

10 - Insulation

I0 = without insulation (standard).
Ii = with internal insulation.
Ia = with external insulation.

11 - Height of plenum box

KHS = standard height of plenum box.
xxx = Height of plenum box in mm, freely selectable (always with 3 digits) (minimum height [GH] with spigot position S1+S2 and standard box neck = spigot diameter $\varnothing D + 82$ mm / with spigot position S0 = 180 mm).

12 - Box neck

KVS = Standard box neck.
xxx = box neck extension in mm, freely selectable (always with 3 digits). Box neck (not adjustable) from ≥ 45 mm to 200 mm possible.

13 - Spigot position

S0 = Spigot from above (standard).
S1 = Lateral spigot.
S2 = Lateral spigot located on the opposite side.

14 - Spigot diameter

SDS = spigot diameter standard.
xxx = spigot diameter ($\varnothing D$) in mm, freely selectable (always with 3 digits).

15 - Suspension

E0 = without riveting nut (standard).
EM = with riveting nut.

SPECIFICATION TEXT

The wall slot diffuser type DSXW is suitable for installation in or at wall systems.

The high induction ensures fast reduction of the air outflow velocity and of the temperature difference. Free cross-section, resistance and noise level remain constant in all air guide element positions.

Air guide element can be removed when the wall slot diffuser is installed.

Volumetric flows in m ³ /h per m at:	35 dB(A)	40 dB(A)
DSXW-1-...	149	177
DSXW-2-...	282	337
DSXW-3-...	348	414
DSXW-4-...	432	520

Supply air model with air guide elements.

Product: SCHAKO type **DSXW-...-Z-...**

Return air model with air guide elements.

Product: SCHAKO type **DSXW-...-A-...**

Model (number of slots):

- 1-slot (-1).
- 2-slot (-2).
- 3-slot (-3).
- 4-slot (-4).

Frame profile:

- narrow frame profile, without support profile, for invisible installation (-S0, standard).
- Frame profile P0, with support profile, for visible installation (-P0).
- Frame profile PB, with support profile, for visible installation (-PB).

Frame surface:

- Natural colour anodised aluminium (-ELOX, standard for model DSXW-...-P0 and DSXW-...-PB).
- Painted aluminium (standard for DSXW-...-S0 model and painted to the same colour as blade colour of air guide element):
 - RAL 9005 (black) (-9005).
 - RAL 9010 (white) (-9010).
 - painted to a different RAL colour (freely selectable, at an extra charge) (-xxxx, always with 4 digits).

Blade colour (air guide element)

Air guide element made of plastic:

- Colour similar to RAL 9005 (black, standard) (-L9005).
- Colour similar to RAL 9010 (white) (-L9010).

Blade position for air jet:

- one-way horizontal throw diagonally upwards (-L, standard)

Length / Model:

Single design (-N)

- Length L= 1000 mm (-N-01000)
- Length L= 1500 mm (-N-01500)
- Length (L) in mm, freely selectable (-N-xxxxx) (always with 5 digits).
(in case of single design length L ≥ 400 mm to ≤ 1500 mm can be fitted with plenum box, dummy piece possible from length ≥ 200 mm).

Band design (-B)

- Length (BL) in mm, freely selectable, as band (-B-xxxxx) (always with 5 digits).
(Available lengths according to SCHAKO standard).
Single element length max. 1500 mm. With double air guide element (1x per connection) and connecting element, supplied loose. To lock the slot diffusers, double air guide elements are used at the butt joints (supplied loose, installation on site).

Mounting:

- without connection (-00)
 - Slot diffuser is **not** connected to the plenum box.
 - Standard with dummy piece (-BS) and with mounting bracket (-BW).
- Concealed mounting with plenum box (-VM, standard)
 - Slot diffuser is connected to the plenum box ex works.
 - The slot diffuser is screwed to the plenum box housing (face part) with concealed screws.
- Clamp strap (-KB)
 - Only possible without plenum box.
 - Screws and clamp straps are supplied loose (pair).
 - Possible for the models DSXW-...-P0 and DSXW-...-PB.
 - Not possible for model DSXW-...-S0.
- The slot diffuser is screwed to the clamp strap with concealed screws (included in delivery).
 - For mounting, access on the rear is not required!
- Suspension via fastening holes
 - Model:
 - dummy piece design (-BS).
 - mounting bracket design (-BW, pair).
 - Only possible without plenum box.
 - The slot diffuser is fastened to 4 suspension brackets.

Accessories:

- Plenum box (-ASK-23) with air diffuser plate made of galvanised sheet steel (-SV).
 - Model (number of slots):
 - 1-slot (-1).
 - 2-slot (-2).
 - 3-slot (-3).
 - 4-slot (-4).
 - Single / band design:
 - Single design (-N, length of box KL max. 1500 mm).
 - Band design (-B, available lengths according to SCHAKO standard for band design).
 - Length:
 - Length L = 1000 mm (-01000) (KL = 995 mm).
 - Length L = 1500 mm (-01500) (KL = 1495 mm).
 - Length (L/BL) in mm, freely selectable (-xxxxx, always with 5 digits) (length of box KL = L-5 / total length of box GKL = BL-5, can be fitted with a plenum box in case of single design lengths L = ≥400 mm to ≤1500 mm).
 - Mounting of box:
 - without connection (-00) (not connected to the slot diffuser, screws supplied loose).
 - Concealed mounting (-VM, standard) (connected to the slot diffuser ex works).
 - Damper:
 - without damper (-DK0) (standard).
 - with damper and cable-operated adjustment (-DK2), made of galvanised sheet steel, in the connection spigot, adjustable, for simple air volume regulation.
 - Rubber lip seal:
 - without rubber lip seal (-GD0, standard).
 - with rubber lip seal (-GD1), made of special rubber, at the connection spigot.
 - Insulation:
 - without insulation (-I0, standard).
 - with internal insulation (-Ii), thermal insulation inside the plenum box.
 - with external insulation (-Ia), thermal insulation at the outside of the plenum box.
 - Height of plenum box:
 - Standard height of plenum box (-KHS).
 - Height of box in mm, freely selectable (-xxx, always with 3 digits) (minimum height [GH] with spigot position S1+S2 and standard box neck = spigot diameter $\varnothing D + 82$ mm / with spigot position S0 = 180 mm).
 - Box neck:
 - Box neck standard (KVS = 45 mm) (-KVS).
 - Box neck extension in mm, freely selectable (-xxx, always with 3 digits). Box neck (not adjustable) from ≥45 mm to 200 mm possible.
 - Spigot position:
 - Spigot from above (-S0) (standard).
 - Lateral spigot (-S1).
 - Lateral spigot located on the opposite side (-S2).
 - Suspension with mounting brackets:
 - without riveting nut (-E0) (standard).
 - With riveting nut (-EM), made of brass.
 - Connection plate for band design (2x per butt joint), made of galvanised sheet steel. Number of suspension (without / with riveting nuts) per butt joint is reduced from 4x to 2x.

- End pieces (-E0 / -ES / -EB / -EL / -ER)
 - without end piece (-E0) (standard).
 - with end pieces:
 - Supplied loose (-ES, pair) (standard).
 - Mounted ex works on both sides (-EB).
 - Mounted ex works on the left side (-EL).
 - Mounted ex works on the right side (-ER).
 Made of aluminium (same colour as frame).
- Mounting bracket (pair) / dummy piece (-B0 / -BW / -BS)
 - without mounting bracket / without dummy piece (-B0).
 - with mounting bracket (-BW), for overflow operation:
 - made of galvanised sheet steel.
 - Only possible without plenum box.
 - possible from length L ≥ 200 mm.
 - with dummy piece (-BS):
 - made of galvanised sheet steel.
 - Only possible without plenum box.
 - possible from length L ≥ 200 mm.
 With models -BW and -BS as a band, additional connecting fishplates are supplied loose.